

# KL-HD1

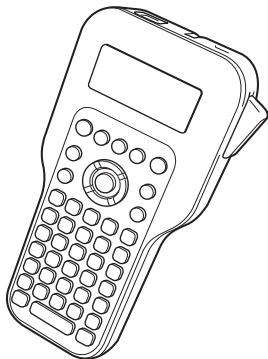

## User's Guide



RJA532737-001V02

**CASIO**<sup>®</sup>

**Important!**

Be sure to keep all user documentation handy for future reference.

## Read This First!

- CASIO COMPUTER CO., LTD. shall not be held liable for any loss or claims by you or any other person or entity that may arise through the use of this printer.
- Reproduction of this manual in any form, either in part or its entirety, is forbidden without the express permission of CASIO COMPUTER CO., LTD.
- The contents of the manual are subject to change without notice.
- The software is continually being revised and updated. Because of this, the software supplied to you and the contents of the displays it produces may be different from those described in this manual, or some items described in this manual may no longer be available.
- Screen shots and examples shown in this manual assume that "English" was selected as the display language. Screens produced when another display language is selected may be different from the screen shots shown here.
- Be sure to read this manual carefully before attempting to use the product for the first time.

## Contents

<b>Safety Precautions .....</b>	<b>2</b>
<b>Operating Precautions .....</b>	<b>4</b>
<b>Part 1 Getting Ready .....</b>	<b>5</b>
<b>Part 2 Inputting Characters and Symbols.....</b>	<b>8</b>
<b>Part 3 Deleting and Inserting Characters.....</b>	<b>10</b>
<b>Part 4 Fonts, Character Sizes and Character Styles.....</b>	<b>10</b>
<b>Part 5 Printing.....</b>	<b>12</b>
<b>Part 6 Configuring Form Settings.....</b>	<b>14</b>
<b>Part 7 Using Frames .....</b>	<b>15</b>
<b>Part 8 Creating and Printing a Label with a Logo .....</b>	<b>15</b>
<b>Part 9 Memory .....</b>	<b>16</b>
<b>Part 10 Configuring the Printer Setup.....</b>	<b>17</b>
<b>Part 11 Reference.....</b>	<b>17</b>
<b>Appendix .....</b>	<b>APP-1</b>

## Safety Precautions

Thank you for purchasing this quality CASIO product.  
Before using it, be sure to read the following Safety Precautions. Keep the manual in a convenient location for future reference when necessary.



### Danger

This symbol indicates information that, if ignored or applied incorrectly, creates the danger of death or serious personal injury.



### Warning

This symbol indicates information that, if ignored or applied incorrectly, creates the possibility of death or serious personal injury.



### Caution

This symbol indicates information that, if ignored or applied incorrectly, creates the possibility of personal injury or material damage.

### Examples of graphic markings



 indicates something you should not do. The symbol shown here indicates you should not try to take the unit apart.



 indicates something you should do.

### Danger

#### Batteries



Perform the following steps immediately if fluid leaking from batteries ever gets into your eyes.

1. Do not rub your eyes! Rinse them with water.
2. Contact your physician immediately.

Leaving alkaline battery fluid in your eyes can lead to loss of sight.

### Warning

#### Smoke, abnormal odor, overheating, and other abnormalities



Do not continue to use this product while it is emitting smoke or strange odor, or generating heat. Continued use creates the risk of fire and electric shock. Immediately perform the following steps whenever any of the above symptoms are present.

1. Turn off power.
2. Contact your original retailer.

#### Batteries



Continued use of the printer without removing the batteries after they have leaked creates the risk of fire and electric shock. Should batteries leak, immediately stop using the printer and contact your original retailer.



Misuse of batteries can cause them to leak, resulting in damage to nearby objects, or to explode, creating the risk of fire and personal injury. Always make sure you observe the following precautions.

- Never try to take batteries apart or allow them to become shorted.
- Never expose batteries to heat or dispose of them by incineration.
- Never mix old batteries with new ones.
- Never mix batteries of different types.
- Do not charge the batteries.
- Make sure the positive (+) and negative (-) ends of the batteries are facing correctly.



#### Dropping and rough treatment



Continued use of the product after it has been damaged due to dropping or other rough treatment creates the risk of fire and electric shock. Immediately perform the following steps if the product should ever become damaged.

1. Turn off power.
2. Contact your original retailer.

## Warning

### Disassembly and Modification



Never try to take this product apart or modify it in any way. Doing so creates the risk of electric shock, burn injury, and other personal injury.

Leave all internal inspection, maintenance, and repair up to your original retailer.

### Liquids and Foreign Matter



Water, sports drinks, seawater, animal or pet urine, or foreign objects (pieces of metal, etc.) getting into this product creates the risk of fire and electric shock.

Immediately perform the steps below whenever any of the above symptoms are present.

1. Turn off power.
2. Contact your original retailer.

### Keep Away From Fire



Never throw this product into fire to dispose of it.

Doing so creates the risk of explosion, which can cause fire or personal injury.

### Packaging Plastic Bag



Take care never to allow the plastic bag this product comes in to be ingested or placed over anyone's head.

Doing so creates the risk of suffocation. Particular care is required in households where small children are present.

### Do not affix labels to a container to be used in a microwave oven.



Do not affix labels to any container you plan to use in a microwave oven. The label material contains metal, which creates the risk of fire and burn injury when heated in a microwave oven. It can also cause deformation of the container to which the label is affixed.

## Caution

### Batteries



Misuse of batteries can cause them to leak, resulting in damage to nearby objects, or to explode, creating the risk of fire and personal injury. Always make sure you observe the following precautions.

- Use only batteries that are specified for use with this product.
- Remove batteries from the product if you do not plan to use it for a long time.

### Keep backup copies of all important data.



Be sure to keep separate copies of important data in a notebook or some other location. Malfunction of the product, repairs, and dead batteries can cause data stored memory to be lost.

### Heavy Objects



Do not place heavy objects on this product. Doing so can cause this product to tip over or fall, creating the risk of personal injury.

### Unstable Locations



Never place the product on an unstable surface, on a high shelf, etc. Doing so can cause the product to fall, creating the risk of personal injury.

### Locations to be Avoided



Never leave this product in any of the types of locations described below.

Doing so creates the risk of fire and electric shock.

- Areas subject to large amounts of humidity or dust.
- Food preparation areas or other locations where oil smoke is present.
- Near heaters, on a heated carpet, in areas exposed to direct sunlight, in a closed vehicle parked in the sun, or other areas subject to very high temperatures.

## Caution

### Loading and replacing batteries



The springs inside of the battery compartment have sharp edges. Take care that you do not touch the springs with your fingers when loading or replacing batteries. Doing so creates the risk of personal injury.

### Display Screen



- Never push on the display screen's LCD panel or subject it to strong impact. Doing so can cause the LCD panel's glass to crack, creating the risk of personal injury.
- Should the LCD panel ever crack or break, never touch the liquid inside of the panel. LCD panel liquid can cause skin irritation.



- Should LCD panel liquid ever get inside your mouth, immediately wash out your mouth with water and contact your physician.
- Should LCD panel liquid ever get into your eyes or onto your skin, rinse with clear water for at least 15 minutes, and then contact a physician.

### High temperature precaution



The print head and the metal parts around it can become very hot. Do not touch them. Doing so creates the risk of burn injury.

### Cutter Precautions



Do not insert your fingers into the print head or the cutter at the tape outlet. Doing so creates the risk of finger cuts and personal injury.

## Operating Precautions

Observe the following precautions to ensure that the printer provides you with the years of trouble-free operation for which it is designed.

- Avoid using the printer in areas exposed to direct sunlight, and in areas subjected to high humidity, electrostatic charge, sudden temperature changes, and temperature extremes. Operating Temperature Range: 10°C to 35°C (50°F to 95°F)
- Battery capacity becomes lower at temperatures of 10°C (50°F) and colder. This can cause the message "**LOW BATTERY!**" to appear sooner than normal. If this happens, move the printer to a location that is within the operating temperature range (10°C to 35°C (50°F to 95°F)).
- Never subject the printer to strong impact or shock.
- Never allow paper clips, pins, or other similar objects to get inside the printer mechanism.
- Never pull on the tape with excessive force or try to push it into the cassette.
- Place the printer on a level surface when printing. A tilted surface can make normal printing impossible.
- Unclear printing can indicate a dirty print head. If printing becomes unclear, use the procedures on page 17 to clean the print head and rubber roller.

### Important!

- Contact a nearby dealer whenever you require servicing.
- Note that the manufacturer shall not be held liable for any loss or claims by third parties, which may arise out of the use of this product.
- Note that the manufacturer shall not be held liable for any damages incurred as a result of data loss caused by malfunctions, repairs, or interruption of power supply.
- It is up to the user to keep backup records of important data.

## Part 1 Getting Ready

### Important!

- Be sure to read this section before attempting to use the printer.

### General Guide

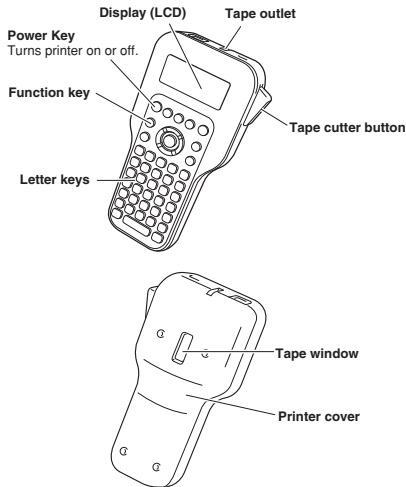

### Power Supply

The printer can run on six AA-size alkaline batteries. Be sure to use alkaline batteries only.

### Replacing Batteries

A handy low battery power indicator lets you know when battery power is getting too low for proper operation. The message "**LOW BATTERY!**" appears on the display if battery power is low when you perform any of the following operations.

- Turn power on
- Execute a print operation

Whenever the "**LOW BATTERY! OK/CANCEL**" message appears, press **OK** to clear it from the display. You should still be able to perform some printer operations, but some power intensive operations (like printing) may become impossible if battery power is too low. In any case, you should replace batteries as soon as possible after the "**LOW BATTERY!**" message appears.

### To load batteries

#### Caution

- The springs inside of the battery compartment have sharp edges. Take care that you do not touch the springs with your fingers when loading or replacing batteries. Doing so creates the risk of personal injury.



1. Turn off the printer.
2. While pressing the location of the up arrow (▲), lift up the printer cover to open and remove it.

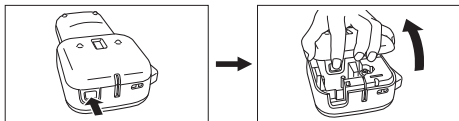

3. Load batteries into the battery compartment.
  - Be sure to use alkaline batteries.
  - Make sure the positive (+) and negative (-) ends of the batteries are facing correctly when you load them.

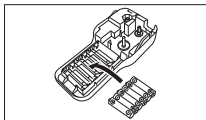

4. Replace the printer cover.



## Turning the Printer On or Off

Press to turn the printer on or off.



- When you turn on the printer, the tape width selection screen will appear. Use ▲ and ▼ to select the tape width you will use, and then press OK.

## Resetting the Memory

You should reset the memory of the printer before using it for the first time.

### Important!

- Resetting the printer memory clears its memory of all input data.

### To reset the memory

1. Make sure that printer power is off.
2. While holding down and the space key, press to turn power on.
  - This prompt confirms whether or not you want to initialize the printer.

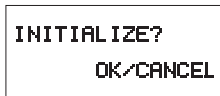

3. Release , the space key, and .
4. Press OK to initialize the printer or to abort the reset operation without initializing anything.

## Display Language Setting

You can select English, German, French, Italian, Spanish, Swedish, Portuguese, or Indonesian as the language to be used for display messages. For information about how to change the language setting, see page 17.



## Auto Power Off Function

If you do not perform any key operation for about six minutes, the printer will turn off automatically. To restore power, press .

- The printer will remember any text you input before power turned off.

## Retrieving a Sentence from Memory

If power is turned off or if Auto Power Off is triggered while you are creating a sentence, the sentence that was being created is saved temporarily in printer memory. The next time you turn on power, the message "[OK] TO RECALL" will appear. Pressing **OK** will display the sentence currently stored in memory.

## Tape Cartridges

Use the procedures described below to load a tape cartridge into the printer.

### Important!

- Never try to push the tape back into the cassette. Once tape is out of the cassette, there is no way to wind it back in. Trying to do so can cause operational problems with the printer.
- The following are the tape widths that can be used with this printer:  
6mm ( $\frac{1}{4}$ " ), 9mm ( $\frac{3}{8}$ " ), 12mm ( $\frac{1}{2}$ " ), 18mm ( $\frac{3}{4}$ " ).

### To load a tape cartridge

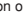
1. Make sure that the printer is turned off.
2. While pressing the location of the up arrow () , lift up the printer cover to open and remove it.

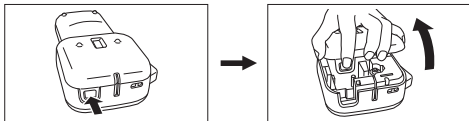

- Never touch the print head or other metal objects near the head. These items become very hot, and touching them creates the risk of burn injury.

3. Remove the stopper from a new tape cartridge and check to see that the tape is ready to use.

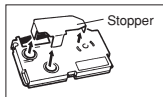

- Make sure that the tape is under the tape guide and that it is not bent or twisted.



4. Pull the tape out about 3cm ( $1\frac{3}{16}$ " ).

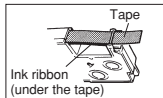

### Important!

- Once tape is pulled out, there is no way to get it back into the cartridge.
- Never use excessive force when pulling on the tape. Doing so can cause the ink ribbon to break, creating the risk of malfunction.

5. Use a pencil or some other thin object to take up slack in the ink ribbon as shown in the illustration. Note that the tape does not move at this time.

- If the ink ribbon is slack when you load it into the printer, it can break or cause some other problem.
- Be sure to turn the ink ribbon take up spool only in the direction indicated by the arrow (a).
- Turn the spool until the other spool (b) starts turning in the direction noted by the arrow. This indicates there is no slack in the ribbon.

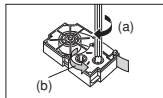
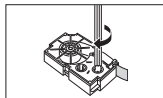

6. Load the tape cartridge into the printer, making sure that the tape and ink ribbon pass between the head and roller.

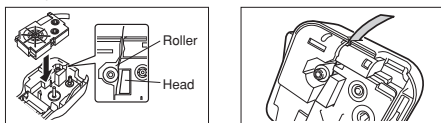

7. Close the printer cover.  
 8. Turn on printer power and press **FUNC** and then  (FEED) two or three times to make sure that the tape comes out without any problem.
- If the tape does not come out normally, turn off power and start again from step 1 above.

## Part 2 Inputting Characters and Symbols

### Important!

- You can input up to 80 characters per label. Further input becomes impossible after you input the 80th character.

### Key Name

- ① OK
- ② Function
- ③ Cancel
- ④ Accent
- ⑤ Number lock
- ⑥ Caps
- ⑦ Space
- ⑧ Return
- ⑨ Backspace
- ⑩ Symbol
- ⑪ Memory (Delete all)
- ⑫ Setup (Feed)
- ⑬ Print (Print preview)
- ⑭ Tape length (Logo)
- ⑮ Character style (Frame)
- ⑯ Character size (Font)

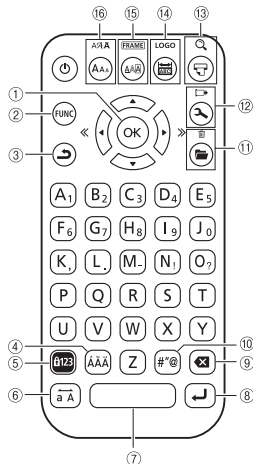

## Display Symbols and Indicators

Before getting into actual input, you should first become acquainted with the symbols and indicators used on the printer display.

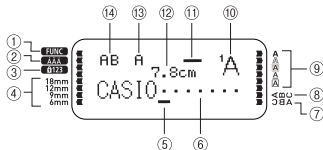

- |                                    |                                       |
|------------------------------------|---------------------------------------|
| ① Function indicator               | ⑧ Vertical text indicator (page 14)   |
| ② Accent indicator (page 9)        | ⑨ Style indicators (page 12)          |
| ③ Number lock Indicator (page 9)   | ⑩ Font Indicator (page 11)            |
| ④ Tape width indicators (page 17)  | ⑪ Imager (page 9)                     |
| ⑤ Cursor                           | ⑫ Tape length (page 14)               |
| ⑥ Character position marks         | ⑬ Character size indicators (page 11) |
| ⑦ Mirror print indicator (page 14) | ⑭ Caps indicator (page 9)             |

## Basic Alpha-Numeric Input

### Note

- If you hold down any key, it will repeat its operation or input at high speed until you release it.

### To input alpha-numeric characters

- Turn on the printer (page 6).
- Specify the tape width.
- Input the first line of characters.
  - To toggle between upper case and lower case input, press  $\overline{a}$   $\overline{A}$ .
  - To input numbers, press  $\overline{123}$ . Pressing  $\overline{123}$  also enables input of symbols ( , . - ! ? ) with the symbol key in the lower right corner of the keyboard.
  - If you input a wrong character, press  $\overline{X}$  to delete it and input again. See page 10 for other details on editing text.

- When you reach the end of a line of text, press  $\overline{\text{↵}}$  to input a newline mark.

- A newline operation is indicated on the display by the  $\overline{\text{↵}}$  symbol. This shows where you changed lines. The Imager shows the number of lines that have been input in the label. Each label line is shown as a horizontal line in the Imager area. The label line currently being edited is indicated by a flashing Imager line.

### Examples

- $\overline{\text{---}}$  Two lines of label text, line 2 being edited
- $\overline{\text{---}}$  Three lines of label text, line 2 being edited

- The maximum number of lines that can be input is one line when the tape width is 6mm ( $\frac{1}{4}$ " ) and 9mm ( $\frac{3}{8}$ " ), two lines when the width is 12mm ( $\frac{1}{2}$ " ), and three lines when the width is 18mm ( $\frac{3}{4}$ " ).
- Input the characters in the second line.
  - To print the text that you input, press  $\overline{\text{↵}}$ . For details on printing, see page 12.

### To input accented characters

- Press  $\overline{\text{ÁÄÅ}}$ .
- Press the key that corresponds to the accented character you want to input.
  - This will display a menu of accented characters.
- Use  $\overline{\text{◀}}$  and  $\overline{\text{▶}}$  to select the accented character you want and then press **OK**.

## Symbols and Illustrations

Pressing  $\overline{\text{\#}}@$  enables input of symbols and illustrations.

### To input symbols and illustrations

- Press  $\overline{\text{\#}}@$ .
- Use  $\overline{\text{▲}}$  and  $\overline{\text{▼}}$  to select the **SYMBOL** or **ILLUST** group, and then press **OK**.
  - This displays a selection screen for the group (**SYMBOL** or **ILLUST**) you selected.
- Use the cursor keys to select the symbol or illustration you want to input and then press **OK**.

## Part 3 Deleting and Inserting Characters

### Moving the Cursor

To make the cursor do this:	Do this:
Move left	Press ◀.
Move right	Press ▶.
Jump to the first (leftmost) text character	Press <b>FUNC</b> then ◀.
Jump to the last (rightmost) text character	Press <b>FUNC</b> then ▶.
Move at high speed	Hold down ◀ or ▶.

### To delete characters

- Use ◀ and ▶ to move the cursor to the right of the character you want to delete.
- Press ✕ to delete the character to the left of the cursor position.
  - If the cursor is located at the first (leftmost) character, pressing ✕ will delete the first character.

### To clear the display

Press **FUNC** and then ☐ (Delete all).

At this time the message "CLEAR? OK/CANCEL" appears on the display to confirm that you want to clear the display. Press **OK** to clear or ↵ to abort the operation without clearing anything.

### To insert characters

- Use ◀ and ▶ to move the cursor to the location where you want to insert the characters.
- Input the new characters.
  - This inserts the characters at the current cursor position.

## Part 4 Fonts, Character Sizes and Character Styles

### Selecting a Font

Your printer gives you a choice of eight fonts (examples shown below). The currently selected font is indicated by an icon (which shows a letter and number) in the upper right corner of the display.

Font	Indicator	Sample
SANS-SERIF	<sup>1</sup> A	ABC
SANS-SERIF RND (Sans-serif Rounded)	<sup>2</sup> A	ABC
ROMAN	<sup>3</sup> A	ABC
COURIER	<sup>4</sup> A	ABC
POP	<sup>5</sup> A	ABC
SLAB SERIF	<sup>6</sup> A	ABC
BORDEAUX HEAVY	<sup>7</sup> A	ABC
CURSIVE	<sup>8</sup> A	ABC

You can specify a font for the text you have just input or you can specify a default font that is used automatically whenever you create a new label.

#### **Important!**

- The font setting is applied to all of the characters. You cannot make multiple specifications for specific characters.

#### ***To change the default font setting***

1. Press **F** to display the **SET UP** menu.
2. Use **▲** and **▼** to select **DEFAULT FONT** and then press **OK**.
3. Use **▲** and **▼** to select the font you want to use as the default, and then press **OK**.
  - The default font you specified will be used initially for all new labels. When inputting text, you can use the procedure above to change the font to another style, if you want.

#### ***To change the font of text you have just input***

1. After inputting the text you want, press **FUNC** and then **A/A** (Font).
2. Use **▲** and **▼** to select the font you want to change to and then press **OK**.
  - This will apply the setting and return to the text input screen.

## **Character Size**

You can select from among four different character sizes: Extra large, Large, Medium, and Small.

Examples of each are shown below.

Extra large	CASIO
Large	CASIO
Medium	CASIO
Small	CASIO

Character size changes are applied to printed text only. The size of displayed text does not change.

#### **Important!**

- The maximum printable character size depends on the width of the tape loaded in the printer and the number of lines of text to be printed.
- The selected character size is applied to all of the characters. You cannot make multiple specifications for specific characters.

#### ***To select a character size***

1. Input the text.
2. Press **A/A** to display the size setting menu.
3. Use **▲** and **▼** to move the pointer to the character size you want to use, and then press **OK**.

## Character Styles

There are six character styles that you can assign: normal, bold, outline shading, underline, and box. Examples of each are shown below.

Style	Indicator	Sample
Normal	None	ABC.XYZ
Bold	<b>A</b>	<b>ABC.XYZ</b>
Outline	A	ABC.XYZ
Shading	A	ABC.XYZ
Underline	A	ABC.XYZ
Box	A	ABC.XYZ

Character style changes are applied to printed text only. The appearance of the displayed text does not change, but the character style indicators will show you when a character style is being used.

### To specify a character style

1. Press **A@A** to display the character style setting screen.
2. Use **▲** and **▼** to move the pointer to the style you want to use, and then press **OK**.

## Part 5 Printing

### Printing Precautions

- Never turn power off while printing is being performed.
- Make sure that the tape outlet is not blocked before you start printing.
- Never operate the tape cutter while printer is being performed (indicated by the message "NOW PRINTING" on the display).

### Important!

- Never touch the tape cutter while a tape cut operation is being performed. Doing so can result in cuts and other personal injury.



### Printing a Tape

Printing a tape is as easy as pressing the  key.

#### To display the print preview

1. Press **FUNC** and then **Q** (PREVIEW).
  - The print image that appears scrolls on the display for easy viewing.
2. To stop the scrolling, press **OK**. Press **OK** again to restart scrolling.
3. Exiting preview will return you automatically to the screen that was displayed prior to starting preview.
  - To cancel preview part way through, press .

#### To print a tape

1. While the text input screen is displayed, press 
  - This will display a screen for specifying the number of copies.
2. Use **◀** and **▶**, to specify the number of copies.
  - You can also input a value for the number of copies.
3. Press **OK** to start printing.
  - To stop a print operation that is in progress, press .
4. After the print operation is complete, press down on the tape cutter button to cut the tape.

### Important!

Check to make sure that printing is completely stopped before cutting the tape. Cutting the tape while printing is in progress can cause tape jams and damage to the printer.

### To affix a tape to a surface

1. Use scissors or some other implement to trim the tape to the required size, if necessary.
2. Remove the backing from the tape and affix it to the desired surface.

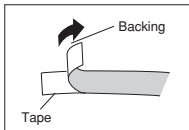

- Bending a corner of the label makes the backing easier to peel off.
- Removing a label from a surface where it was affixed may cause adhesive residue to remain on the surface.

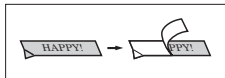

### Important!

Do not try to affix a label to the objects or in the locations described below.

- On a surface exposed to direct sunlight or rain
- On the body of a person or animal
- On a utility pole, on a fence or structure not owned by you, etc.
- On a container used for heating in a microwave oven

### Unsuitable Surfaces (Label may not stick.)

- Rough surfaces
- Surfaces that are wet, oily, dusty, or covered with other matter
- Special plastic materials (silicon, polypropylene, etc.)





### To feed the Tape



1. Press **FUNC** and then  (FEED).
  - This will feed the tape approximately 19mm ( $\frac{12}{16}$ ").

## Part 6 Configuring Form Settings

You can use the procedure in this section to configure direction, mirror, alignment, pitch, and tape length settings.

### Configuring Direction, Mirror, Align, and Pitch Settings

1. Input the text you want.
2. Press .
3. Use  and  to select the item you want to change and then press **OK**.
4. Use  and  to change the setting.
5. Press **OK** to return to the text input screen.

When this setting is selected:	Use  and  to select the option you want:
<b>DIRECTION</b>	<ul style="list-style-type: none"><li>• <b>HORIZONTAL</b>: Positions text from left to right.</li><li>• <b>VERTICAL</b>: Positions text from top to bottom.</li></ul>
<b>MIRROR</b>	<ul style="list-style-type: none"><li>• <b>NORMAL</b>: Prints the tape normally.</li><li>• <b>MIRROR</b>: Prints the tape in mirror image onto special optionally available iron transfer tape.</li></ul>
<b>ALIGN</b>	<ul style="list-style-type: none"><li>• <b>LEFT</b>: Aligns text flush left.</li><li>• <b>CENTER</b>: Centers text.</li><li>• <b>RIGHT</b>: Aligns text flush right.</li><li>• <b>EQUAL</b>: Equally spaces text to fill the entire space available.</li></ul>
<b>PITCH</b>	<ul style="list-style-type: none"><li>• Specify one of the following settings for the pitch (space between characters): "<b>NONE</b>" (0 mm), "<b>NARROW</b>" (1 mm), or "<b>WIDE</b>" (2 mm). Changing this setting also causes the tape length to change accordingly.</li><li>• This setting cannot be changed when <b>EQUAL</b> is selected for the <b>ALIGN</b> setting, and when <b>FIX</b> is selected for the <b>TAPE LENGTH</b> setting.</li></ul>

### Tape Length Setting







You can use either of the methods below to specify the tape length.

- **AUTO**: Automatically adjusts tape length in accordance with the number of characters.
- **FIX**: Maintains a fixed tape length in the range of 0cm (0") to 99.9cm (39 <sup>5</sup>/<sub>16</sub>").

#### To have tape length set automatically (AUTO)

1. Press .
2. Use  and  to select **AUTO**, and then press **OK**.

#### To specify a fixed tape length (FIX)

1. Press .
2. Use  and  to select **FIX**.
3. Use  and  to specify the tape length and then press **OK**.
  - Each press of  (-) or  (+) changes the current length setting by 0.1.
  - You can also input a value for the tape length.

#### Note

- Brackets to the left and right of the display tape length value provide the information described below.  
[xx.x cm]: Print will be the specified length.  
(xx.x cm): Print will be the specified length, but text will be compressed horizontally.  
xx.x cm]: Print will be longer than that specified length.



## Part 7 Using Frames

The printer comes with a selection of built-in frames that you can use in your tape labels. See page APP-4 for a list of frames that are available.

### *To create a framed label*

1. Input the text you want.
  - Including a frame in a label affects the allowable number of lines for each tape wide as shown below.  
18mm ( $\frac{3}{4}$ " ) tape: Up to two lines  
12, 9, 6mm ( $\frac{1}{2}$ ,  $\frac{3}{8}$ ,  $\frac{1}{4}$ " ) tape: One line
2. Press **FUNC** and then **FRAME** (Frame).
3. Use the cursor keys to select the frame you want, and then press **OK**.
4. Use **▲** and **▼** to select **PRINT**, and then press **OK**.
5. Specify the number of copies and then press **OK** to start printing.
  - The **SHADING**, **UNDERLINE**, and **BOX** character style settings cannot be applied when printing with a frame.

## Part 8 Creating and Printing a Label with a Logo

Your printer comes with 60 built-in logos that you can incorporate into your tape labels quickly and easily.

### *To create a label with a logo*

#### **Important!**

- You can incorporate built-in logos into tape labels that are printed using 12mm ( $\frac{1}{2}$ " ) or 18mm ( $\frac{3}{4}$ " ) tape only.
1. Press **FUNC** and then **LOGO** (LOGO).
  2. Use **▼** and **▲** to select the group you want to use, and then press **OK**.
    - For details, see "Built-in Logos" on page 21.
  3. Use **▼** and **▲** to select the logo you want to use, and then press **OK**.
  4. Use **▼** and **▲** to select the language you want to use, and then press **OK**.
  5. Use **▼** and **▲** to select **PRINT** and then press **OK**.
  6. Specify the number of copies and then press **OK** to start printing.



## Part 9 Memory

You can store two blocks of text in memory, containing up of 80 characters.



### Important!

- Be sure to keep written backup copies of all important data.

### To store text

1. Input the text you want to store.
2. Press .
3. Use **▼** and **▲** to select **STORE**.
4. Press **OK**.
5. Use **▼** and **▲** to select the location where you want to store the text and then press **OK**.
6. Press **OK** to store the text or  to abort the store procedure without storing anything.
  - If there is nothing stored at the memory location you selected yet, pressing **OK** will store your text.
  - If there is already text stored at the location, the message "**OVERWRITE? OK/CANCEL**" will appear when you press **OK**. Press **OK** again to replace the existing text with the new text, or  to cancel the store operation.

### To recall text

1. While the input screen is on the display, press 
  - Note that recalled text will replace any input text currently on the display.
2. Use **▼** and **▲** to select **RECALL**.
3. Press **OK**.
4. Use **▼** and **▲** to select the text you want to recall and then press **OK**.
5. Press **OK** to recall the text or  to cancel the recall operation.
  - This recalls the text.
  - If all of the recalled text does not fit on the display, you can use **◀** and **▶** to scroll it to the left and right.
  - Note that recalling text replaces anything that is currently on the input display. Recalled text cannot be appended to existing text.

### To delete stored text

1. While the input screen is on the display, press .
2. Press **▼** and **▲** to select **DELETE**.
3. Press **OK**.
4. Use **▼** and **▲** to select the text you want to delete and then press **OK**.
  - This will display the message "**DELETE? OK/CANCEL**" to confirm.
5. Press **OK** to delete the text.

## Part 10 Configuring the Printer Setup

The printer has a **SET UP** screen that you can use to configure a variety of basic settings.

### To configure the printer setup

1. Press **OK**.
2. Use **▼** and **▲** to select the **SET UP** item whose setting you want to change, and then press **OK**.
3. Use the cursor keys to change the currently selected setting.

When this setting is selected:	Change its setting like this:
<b>TAPE WIDTH</b>	• Use <b>▲</b> and <b>▼</b> to select the tape width setting you want to use.
<b>DEFAULT FONT</b>	• Use <b>▲</b> and <b>▼</b> to select the font you want to use.
<b>CONTRAST</b>	• Use <b>◀</b> and <b>▶</b> to adjust the display contrast.
<b>DENSITY</b>	• Use <b>◀</b> and <b>▶</b> to adjust the print density setting.
<b>LANGUAGE</b>	• Use <b>▲</b> and <b>▼</b> to select the display language you want to use.
<b>cm/inch</b>	• Use <b>▲</b> and <b>▼</b> to select centimeters (cm) or inches as the unit of measurement.

4. Press **OK** to apply the setting.

## Part 11 Reference

### Cleaning the Printer Head and Roller

A dirty printer head and roller can result in poor print quality. If you have problems with print quality, use the following procedure to clean the printer head and roller.

#### To clean the printer head and roller

1. Make sure the printer is turned off.
2. Open the printer cover.
  - If a tape cartridge is loaded in the printer, remove it.
3. Use a cotton swab dipped in alcohol to clean the printer head and roller as shown in the illustration.

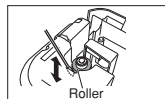
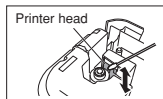

- Never touch the print head or other metal objects near the head. These items become very hot, and touching them creates the risk of burn injury.
4. Replace the tape cartridge and close the printer cover.

#### Cleaning the Printer Exterior

Wipe the exterior of the printer with a cloth moistened with plain water. Wring all excess liquid from the cloth before wiping the printer. Never use benzene, alcohol, thinner, or other volatile agents to clean the printer exterior. Doing so can damage the case.

## Troubleshooting

### • Power Supply

Nothing appears on the display.		
Possible Causes	Action	Page
Battery power is low or the wrong type of batteries are loaded in the printer.	Load a fresh set of AA-size alkaline batteries (supplied by you).	5
Improper display contrast setting	Adjust display contrast.	17
Batteries loaded incorrectly	Remove batteries and reload them correctly.	5

### • Text Input

Cannot input text.		
Possible Causes	Action	Page
FUNC key has been pressed.	Press  to clear FUNC key operation.	8

### • Printing

Tape does not come out when  is pressed.		
Possible Causes	Action	Page
Tape cartridge compartment cover is not closed completely.	Securely close the printer cover.	7
No more tape left in the cartridge.	Replace the tape cartridge with a new one.	7
Tape jam	Remove the tape cartridge and pull out the jammed tape by hand. Cut off excess tape with scissors, and carefully replace the cartridge into the label printer.  <b>Important!</b> Never allow the tape outlet to become blocked and never touch tape as it is being fed during printing.	7
Printing is blurred, blotched, broken, etc.		
Possible Causes	Action	Page
Improper print density setting	Adjust the print density setting.	17
Improper loading of the cartridge	Remove the tape cartridge and reload it correctly.	7
Dirty printer head or rubber roller	Clean the printer head and roller.	17
Printer powers down while printing is in progress.		
Possible Causes	Action	Page
Battery power is low or the wrong type of batteries are loaded in the printer.	Load a fresh set of AA-size alkaline batteries (supplied by you).	5

Ink ribbon is being fed from the tape outlet along with the tape.		
Possible Causes	Action	Page
Tape cartridge loaded while the ink ribbon is slack.	Remove the tape cartridge and check to make sure the ink ribbon is not broken. Next, take up any slack in the ink ribbon and then reload the tape cartridge.  <b>Important!</b> <ul style="list-style-type: none"> <li>• Before loading a tape cartridge into the label printer, always make sure you take up any slack in the ink ribbon first.</li> <li>• If the ink ribbon is broken, you must change to another tape cartridge.</li> </ul>	7

#### • Tape Cutting

Cannot cut tape.		
Possible Causes	Action	Page
Tape cutter blade is dull.	Take the label printer to the dealer from whom you purchased it to have the tape cutter blade replaced.	—
Printed text is cut off by tape cut operation.		
Possible Causes	Action	Page
Out of tape	Replace the tape cartridge with a new one.	7

#### • Using Labels

Label will not adhere to a surface.		
Possible Causes	Action	Page
The backing paper is still on the back of the tape.	Peel the backing paper from the back of the tape to expose the adhesive.	13
Surface is unsuitable for affixing a tape.	Labels do not adhere well to surfaces that are rough, wet, oily, or dirty.	13

## Error Messages/Display Messages

Message	Possible Causes	Action
LABEL LONGER THAN SETTING! OK/CANCEL	<ul style="list-style-type: none"> <li>This message appears when the length of the tape that will actually be printed is longer than the specified tape length.</li> </ul>	<ul style="list-style-type: none"> <li>To print, press <b>OK</b>.</li> <li>To cancel printing, press <b>↵</b>. You can then decrease the number of characters, change to a longer tape setting, or select auto tape length.</li> </ul>
LOAD A TAPE CARTRIDGE 12mm OR 18mm	<ul style="list-style-type: none"> <li>You are trying to use the Logo function while a 6mm (<math>\frac{1}{4}</math>" ) or 9mm (<math>\frac{3}{8}</math>" ) tape cartridge is loaded in the printer.</li> </ul>	<ul style="list-style-type: none"> <li>Turn off the printer and replace the tape cartridge with a 12mm (<math>\frac{1}{2}</math>" ) or 18mm (<math>\frac{3}{4}</math>" ) cartridge, and specify the tape width setting on the printer.</li> </ul>
LOW BATTERY!	<ul style="list-style-type: none"> <li>Battery power is low.</li> </ul>	<ul style="list-style-type: none"> <li>Replace the batteries.</li> </ul>
NO DATA!	<ul style="list-style-type: none"> <li>You are attempting to recall text from memory when there is none stored.</li> </ul>	<ul style="list-style-type: none"> <li>Store the text in memory and then try again.</li> </ul>
NO INPUT TEXT!	<ul style="list-style-type: none"> <li>You are attempting a print or preview operation when no text is input.</li> </ul>	<ul style="list-style-type: none"> <li>Input the text and then try again.</li> </ul>
PRINT ERROR!	<ul style="list-style-type: none"> <li>The tape became jammed during printing.</li> </ul>	<ul style="list-style-type: none"> <li>Turn off the printer and remove the tape cartridge. Next, remove the jammed tape.</li> <li>If the steps described above do not clear the error message, contact your retailer or your nearest CASIO service center.</li> </ul>

Message	Possible Causes	Action
PRINTER NOT SHUT DOWN PROPERLY LAST TIME	<ul style="list-style-type: none"> <li>You removed the batteries the last time power was turned on or while the message <b>"PLEASE WAIT"</b> was displayed, so the printer did not power down normally.</li> </ul>	<ul style="list-style-type: none"> <li>Press any key to initialize the data that was partially deleted the last time the printer powered down.</li> </ul>
TOO MANY CHARACTERS!	<ul style="list-style-type: none"> <li>You are attempting to input more than 80 characters of text.</li> </ul>	<ul style="list-style-type: none"> <li>Reduce the number of input characters.</li> </ul>
TOO MANY LINES!	<ul style="list-style-type: none"> <li>The number of line breaks you input caused the label to exceed the maximum number of lines for the tape you are using.</li> <li>You are attempting to print more than three lines while an 18mm (<math>\frac{3}{4}</math>" ) tape cartridge is loaded.</li> <li>You are attempting to print more than two lines while a 12mm (<math>\frac{1}{2}</math>" ) tape cartridge is loaded.</li> <li>You are attempting to print more than one line while a 6mm (<math>\frac{1}{4}</math>" ) or 9mm (<math>\frac{3}{8}</math>" ) tape cartridge is loaded.</li> </ul>	<ul style="list-style-type: none"> <li>Use wider tape or reduce the number of lines. The maximum number of lines for each tape width is shown below. 6mm (<math>\frac{1}{4}</math>" ) tape...1 line 9mm (<math>\frac{3}{8}</math>" ) tape...1 line 12mm (<math>\frac{1}{2}</math>" ) tape...Up to 2 lines 18mm (<math>\frac{3}{4}</math>" ) tape...Up to 3 lines</li> <li>Use wider tape or reduce the number of lines with frame. The maximum number of lines for each tape width when printing with a frame is shown below. 6mm (<math>\frac{1}{4}</math>" ) tape...1 line 9mm (<math>\frac{3}{8}</math>" ) tape...1 line 12mm (<math>\frac{1}{2}</math>" ) tape...1 line 18mm (<math>\frac{3}{4}</math>" ) tape...Up to 2 lines</li> </ul>

## Built-in Logos

### ● PRICE Labels



### ● SIGN Labels

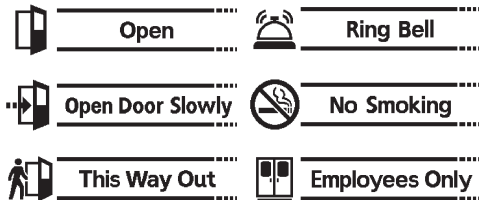

● WORK Labels

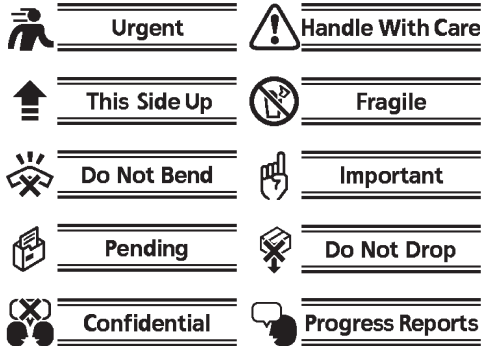

● ATTENTION





## Specifications

**Model:** KL-HD1

### Input

Keyboard Layout: Alphabetic (ABCD)

Number of characters: 80

### Character Types

Alpha (English and other languages): 231

Numbers: 10

Symbols: 426

### Display

Type: Liquid crystal display

Character matrix: 96 × 32 dots, 12 columns × 1 line

### Printing

Resolution: 96 dots/200dpi

Type: Thermal transfer

Speed: Up to approximately 10mm ( $\frac{3}{8}$ " )/second (normal conditions)

Width: 4mm ( $\frac{1}{8}$ " ) (6mm ( $\frac{1}{4}$ " ) tape), 7mm ( $\frac{1}{4}$ " ) (9mm ( $\frac{3}{8}$ " ) tape), 10mm ( $\frac{3}{8}$ " ) (12mm ( $\frac{1}{2}$ " ) tape), 12mm ( $\frac{1}{2}$ " ) (18mm ( $\frac{3}{4}$ " ) tape)

Character Matrix: 48 × 48-dot

Character fonts: SANS-SERIF, SANS-SERIF RND, ROMAN, COURIER, POP, SLAB SERIF, BORDEAUX HEAVY, CURSIVE

Character Styles: Normal, bold, outline, shading, underline, box

Character sizes: Small, Medium, Large, Ex.Large

Number of lines: 1 (6mm ( $\frac{1}{4}$ " ) and 9mm ( $\frac{3}{8}$ " ) tapes); 1 or 2 (12mm ( $\frac{1}{2}$ " ) tape); 1 or 2 or 3 (18mm ( $\frac{3}{4}$ " ) tape)

Number of lines with frame: 1 (6mm ( $\frac{1}{4}$ " ), 9mm ( $\frac{3}{8}$ " ) and 12mm ( $\frac{1}{2}$ " ) tapes); 1 or 2 (18mm ( $\frac{3}{4}$ " ) tape)

### Memory

Text: Up to 80 characters

### General

Power supply: Six AA-size alkaline batteries

Rated voltage: 9V DC

Power consumption: 1A (9W)

Auto Power Off: Approximately six minutes after last key operation.

Dimensions: 202(H) × 112(W) × 60(D) mm ( $7\frac{15}{16}$ "H ×  $4\frac{7}{16}$ "W ×  $2\frac{3}{8}$ "D)

Weight: Approximately 340 g (12 oz) excluding batteries

Ambient Temperature: 10°C to 35°C (50°F to 95°F)

### Battery Life

- Printing of approximately four 18mm ( $\frac{3}{4}$ " ) tape cartridges under standard printing conditions\*

\* Printing text or graphics that contain large areas of black, and printing under cold temperatures can shorten battery life.

## Appendix

### Accented Characters

A	À Á Â Ã Ä Å Æ Ā Ă Ą
C	Ç Ć Ĉ Ċ Ć
D	Ð Ď
E	È É Ê Ë Ē Ę Ě
G	Ĝ Ğ Ġ Ğ
H	Ĥ Ħ
I	Ì Í Î Ï Ĩ Ī Ĭ Ĳ
J	Ĵ
K	Ķ
L	Ĺ Ľ Ļ Ł
N	Ñ Ñ Ñ Ñ Ñ
O	Ò Ó Ô Õ Ö Ø Ò Ó Œ
R	Ŕ Ŗ Ŗ

S	Ś Ŝ Ş Š Š
T	Ŧ Ț Ț Ț Ț
U	Ù Ú Û Ü Ũ Ū Ŭ Ů Ű
Y	Ý Ÿ
Z	Ž Ž Ž

a	à á â ã ä å æ ā ǻ ą
c	ç ć ĉ ċ ċ
d	ď d' đ
e	è é ê ë ē è ę ě
g	ĝ ģ ğ ģ
h	ĥ ħ
i	ì í î ï ĭ ĭ ĭ ĭ ĭ ĭ ĭ ĭ
j	ĵ
k	ķ κ
l	ĺ ł ľ ł
n	ñ n' n' n' n'
o	ò ó ô õ ö ø õ ó œ
r	ř r, ř
s	ś ŝ ș ș ş ß

t	ţ ț ʈ ʈ ʈ ʈ ʈ
u	ù ú û ü ũ ū ŭ ũ ú ư
y	ý ÿ
z	ž ž ž

## Symbols

### ● SYMBOL

, . : ; · ? ! @ # \$ % & ' " " „ « » ( ) [ ] { } < >  
« » / \ \$ € £ Rp ¥ # & \* @ § % ‰ + - × ÷ ± =  
≠ < > ≅ ≅ - \_ — ~ | ¡ ¢ £ ¤ ¥ ¦ § ¨ © ª « ¬ ® ¯ ° ± ² ³ ´ µ ¶ · ¸ ¹ º » ¼ ½ ¾

### ● DINGBAT



### ● NUMBER

0 1 2 3 4 5 6 7 8 9 0 1 2 3 4 5 6 7 8 9

### ● GREEK

Α Β Γ Δ Ε Ζ Η Θ Ι Κ Λ Μ Ν Ξ Ο Π  
Ρ Σ Τ Υ Φ Χ Ψ Ω α β γ δ ε ζ η θ  
ι κ λ μ ν ξ ο π ρ σ τ υ φ χ ψ ω

## Illustrations

### ● ILLUSTR 1

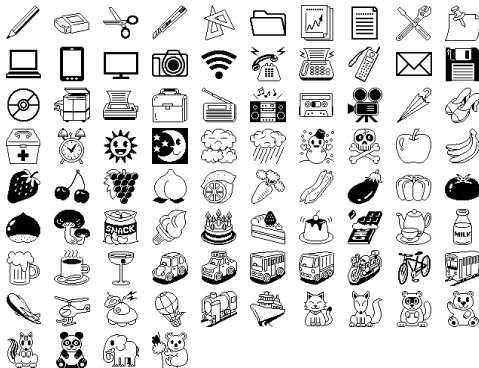

● ILLUSTR 2

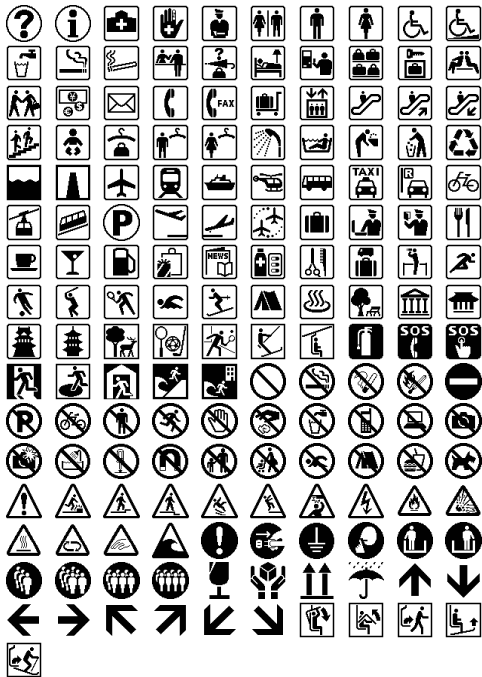

Frames

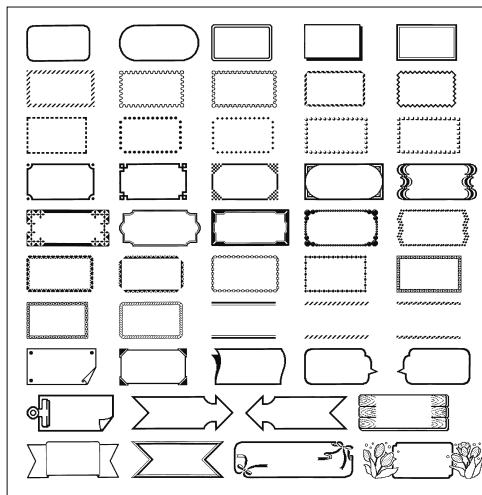

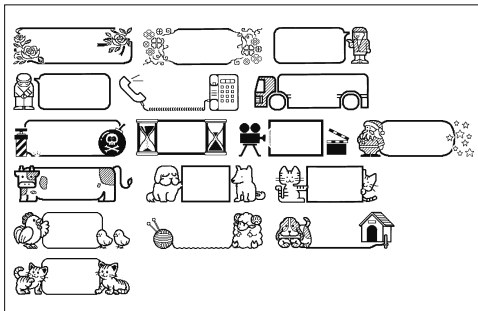



Manufacturer:

CASIO COMPUTER CO., LTD.

6-2, Hon-machi 1-chome, Shibuya-ku, Tokyo 151-8543, Japan

Responsible within the European Union:

CASIO EUROPE GmbH

Casio-Platz 1, 22848 Norderstedt, Germany

[www.casio-europe.com](http://www.casio-europe.com)

# CASIO®

**CASIO COMPUTER CO., LTD.**  
6-2, Hon-machi 1-chome  
Shibuya-ku, Tokyo 151-8543, Japan



MI 72EU011

MO1502-B Printed in China/Imprimé en Chine

© 2015 CASIO COMPUTER CO., LTD.