

brother



PT-2040SC/PT-2040W
User's Guide

English

PT-2040

User's Guide

English

Thank you for purchasing Brother's PT-2040. Use your new PT-2040 label maker to create labels for multiple applications. Select from the many frames, character sizes, and styles to design beautiful custom labels. In addition, the variety of Tape Cassettes available allows you to print labels with different widths and exciting colors.

Please read this guide, including all Precautions, before using this machine. After reading this guide, keep it in a safe place.

D019JD001



General Precautions

- Depending on the location, material, and environmental conditions, the label may unpeel or become irremovable, the color of the label may change or be transferred to other objects. Before applying the label, check the environmental conditions and the material.
- Do not use the label maker in any way or for any purpose not described in this guide. Doing so may result in accidents or damage the label maker.
- Use Brother TZe tapes with the label maker. Do not use tapes that do not have the **TZe** mark.
- Only use a soft, dry cloth to clean the label maker; never use alcohol or other organic solvents.
- Use a soft, lint free cloth to clean the print head. Never touch the print head directly with your hands.
- Do not put any foreign objects into the tape exit slot, AC Adapter connector, battery compartment, etc.
- Do not place the label maker / batteries / AC Adapter in direct sunlight or rain, near heaters or other hot appliances, in any location exposed to extremely high or low temperatures (e.g., on the dashboard or in the back of your car) or high humidity, or in dusty locations.
- Do not apply excessive pressure to the Tape Cutter Lever.
- Do not try to print if the cassette is empty; it will damage the print head.
- Do not pull the tape while printing or feeding; it will damage the tape and the label maker.
- Any data stored in memory will be lost due to failure, repair of the label maker, or if the battery expires.
- The label maker is not equipped with a charging feature for rechargeable batteries.
- The printed text may differ from the text that appears on the LCD.
- The length of the printed label may differ from the displayed label length.
- A protective clear plastic sticker is placed over the display during manufacturing and shipping. This sticker should be removed prior to use.
- When power is disconnected for more than five minutes, all text, format settings and any text files stored in the memory will be cleared.

Safety Precautions

! WARNING

Indicates a potentially hazardous situation which, if not avoided, could result in death or serious injuries.

Follow these guidelines to avoid the risk of fire, burns, injury, electric shocks, rupture, overheating, abnormal odors or smoke.

- When the label maker is not being used, store it out of the reach of children. In addition, do not allow children to put the label maker parts or labels in their mouths. If any object has been swallowed, seek medical attention.
- Always use the specified voltage and the suggested AC Adapter (AD-24ESA-01/AD-24ESAW-01) for the label maker to prevent any damage or failure.
- Do not touch the label maker during a lightning storm.
- Do not use the label maker / AC Adapter in places of high humidity such as bathrooms.
- Do not overload the power cord.
- Do not place heavy objects on, or damage the power cord or plug. Do not forcibly bend or pull the power cord. Always hold the AC Adapter when disconnecting from the power outlet.
- Make sure that the plug is fully inserted to the power outlet. Do not use an outlet that is loose.
- Do not allow the label maker / AC Adapter / power plug / batteries to get wet, for example, by handling them with wet hands or spilling beverages on to them.
- Loss of eyesight may result when leaked fluid from batteries gets into your eyes. If leaked fluid gets into your eyes, immediately rinse your eyes with a large amount of clean water, and then immediately seek medical attention.
- Do not disassemble or modify the label maker / AC Adapter / batteries.
- Do not allow metal objects to contact the battery.
- Do not use sharp objects, such as tweezers or a metallic pen, to change the batteries.
- Do not throw the batteries into fire or expose to heat.
- Disconnect the AC Adapter and remove batteries immediately and stop using the label maker if you notice abnormal odor, heat, discoloration, deformation or anything unusual while using or storing it.
- Do not use a damaged or leaking battery as the fluid may get on your hands.
- Do not use a deformed or leaking battery or one whose label is damaged. There is a possibility of generating heat.

! CAUTION

Indicates a potentially hazardous situation which, if not avoided, may result in minor or moderate injuries.

Follow these guidelines to avoid personal injury, liquid leakage, burns or heat.

- Do not touch metal parts around the print head immediately after printing.
- Do not touch the cutter blade.
- If leaked fluid from batteries gets on your skin or clothes, immediately rinse them with clean water.
- Remove the batteries and disconnect the AC Adapter if you do not intend to use the label maker.
- Do not use a battery other than that specified. Do not use combinations of old and new batteries or combinations of different types, different charging levels, different manufacturers or different models. Do not insert a battery with its plus and minus ends reversed.
- Do not drop or hit the label maker / AC Adapter.
- Do not press on the LCD display.
- Do not put your finger inside the label maker when you close the Cassette Cover.

1 GETTING STARTED

Installing Power Supply

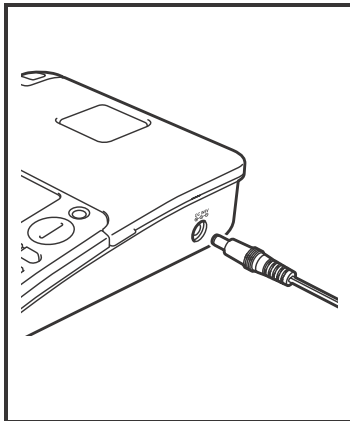

When using AC Adapter (AD-24ESA-01/AD-24ESAW-01):

1. Insert the Power Adapter cord into the AC Adapter Jack on the side of the machine.
2. Insert the Power Adapter into a standard AC electrical outlet.

Battery Compartment Cover

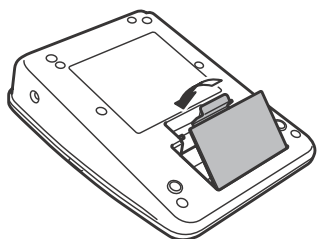
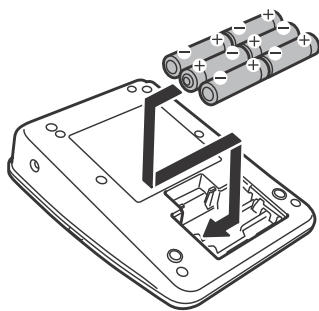
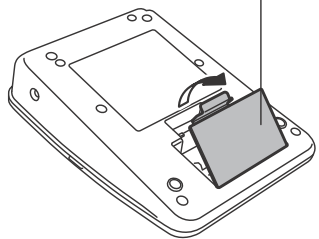

When using batteries:

1. Make sure the power is off.

2. With the LCD facing down, remove the Battery Compartment Cover by pressing the grooved tab and pushing in the direction of the arrow, as illustrated.

3. This label maker requires six (6) AA alkaline batteries, not included. Make sure that the positive (+) and negative (-) ends of the batteries match the marks inside the battery compartment.

Note:

Always replace all six batteries at the same time using brand new ones.

4. Attach the Battery Compartment Cover by inserting the three hooks at the bottom into the slots on the machine, then press down firmly until it clicks into place.

When running a memory backup, we recommend using both the Power Adapter AND batteries, in the event that one or the other power method fails.

Installing a Tape Cassette

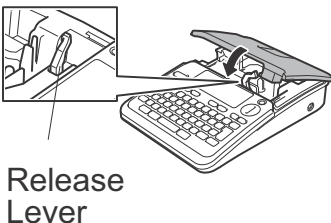
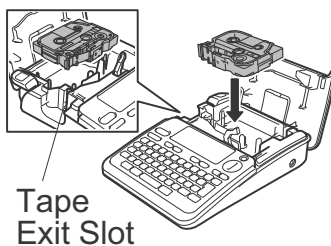
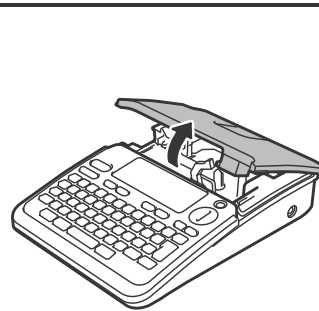

1. Open the Cassette Cover by lifting both sides at the same time.

2. Insert the Tape Cassette following the drawing marked inside the case. Gently press the Tape Cassette into the label maker until it clicks into place.

- Use only tape widths of 0.13" (3.5 mm), 0.23" (6 mm), 0.35" (9 mm), 0.47" (12 mm) or 0.70" (18 mm).
- If your TZe tape is packaged with protective plastic, be sure to remove the plastic before inserting the Tape Cassette.
- Use Brother TZe tapes with this machine.

3. Close the Cassette Cover and gently press until it clicks into place.

LCD and Keyboard

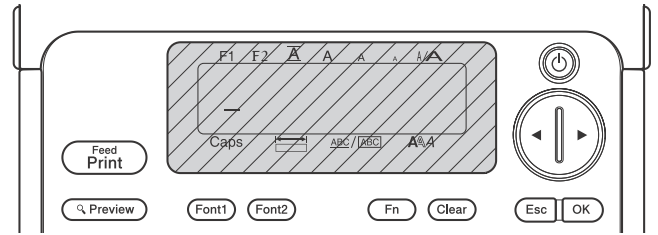
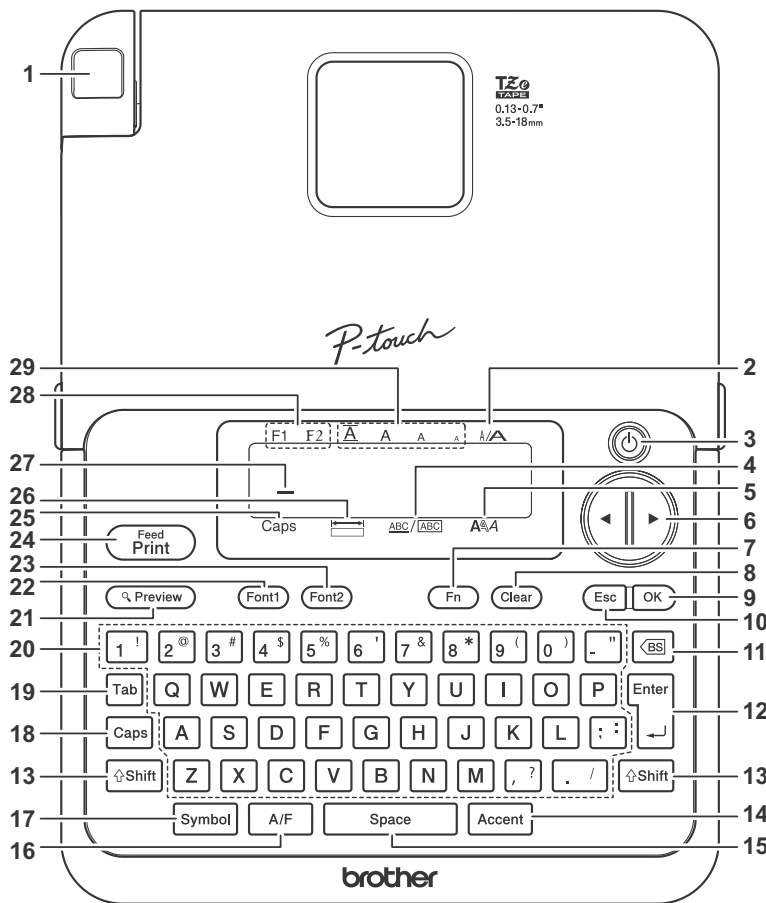

► Removing the protective film

To protect your machine from scratching during shipping, a protective film was placed on the LCD.

Make sure to remove the protective film before using the machine.

- | | |
|----------------------|---------------------------|
| 1. Tape Cutter Lever | 15. Space key |
| 2. Width | 16. Auto Format (A/F) key |
| 3. Power key | 17. Symbol key |
| 4. Underline / Frame | 18. Caps key |
| 5. Style | 19. Tab key |
| 6. Cursor key | 20. Character key |
| 7. Function (Fn) key | 21. Preview key |
| 8. Clear key | 22. Font1 key |
| 9. OK key | 23. Font2 key |
| 10. Escape key | 24. Feed/Print key |
| 11. Backspace key | 25. Caps |
| 12. Enter key | 26. Label Length |
| 13. Shift key | 27. Cursor |
| 14. Accent key | 28. Font |
| | 29. Size |

● NOTE

- The LCD displays one row of 15 characters; however, there is a maximum of 80 characters (including spaces, tabs, symbols, and a return) for a label.
 - When selecting the settings, press Space to return to the default item.
- Pressing the Preview key (21) displays a preview of the label, and may differ from the actual label when printed.
 - Label length shown on the LCD may differ slightly from the actual length when printed.

Supplies and Accessories

For a complete list of tapes compatible with your machine, see your model's page at support.brother.com.

Tape

Cassettes: Brother TZe tapes with  mark.
0.13" (3.5 mm), 0.23" (6 mm),
0.35" (9 mm), 0.47" (12 mm),
0.70" (18 mm)
See the included *Supplies and Accessories Guide*.

AC Adapter: AD-24ESA-01/
AD-24ESAW-01

Print Head

Cleaning

Cassette: TZe-CL4

Specifications

Dimensions: (W x D x H) Approx. 6.5" x 8.6" x 2.7"
(Approx. 164 mm x 218 mm x 58 mm)

Weight: Approx. 1.3 lb. (Approx. 570 g)
(without batteries and Tape Cassette)

Power Supply:

- AC Adapter (AD-24ESA-01/
AD-24ESAW-01)
- Batteries (not included)
Six AA alkaline batteries (LR6)

Tape Cassette: Brother TZe tape (width)
0.13" (3.5 mm), 0.23" (6 mm),
0.35" (9 mm), 0.47" (12 mm),
0.70" (18 mm)

For FAQs and to download manuals, visit:
support.brother.com.

Initial Settings

1 Turn your machine on.

Supply power by using the AC Adapter (included) or six AA batteries (not included), and then press .

2 Set the language.

The default setting is [English].



3 Set the unit of measurement.

The default setting is [inch].

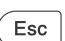

NOTE

- The machine automatically turns off if no keys are pressed within five minutes.
- To cancel any operation, press .

2 BASIC USAGE

Entering Text

You can enter a maximum of 80 characters (including spaces, tabs, symbols, and a return) for a label.

► Switching Upper Case / Lower Case

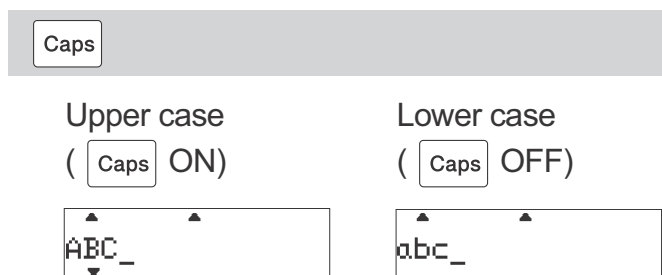

► Creating Two-Line Labels

Move the cursor to where you want to start the next line and press . Use either 0.35" (9 mm), 0.47" (12 mm), or 0.70" (18 mm) tape for two-line printing.

● NOTE

- The return symbol () appears when you press the Enter key .

Display

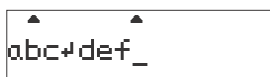

Label image

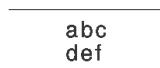

► Entering Tabs

Move the cursor to where you want to set a tab and press .

● NOTE

- The tab symbol appears when you insert a tab in the text.

Display

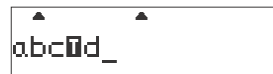

Label image

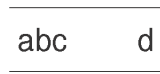

► Changing Tab Length

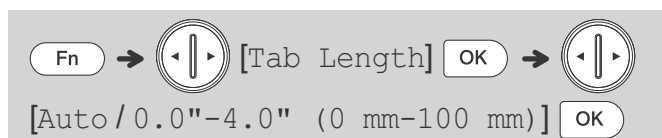

- To return to the default tab length, press .
- Please note: the default length varies based on your tape size.

► Cursor Keys

To move to the end of your text:



To move to the beginning of your text:

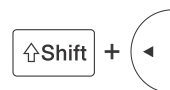

► Entering Accented Characters



- Refer to the **Accented Characters** table in this guide.
- The order of accented characters varies based on the language you selected.

► Changing Label Length

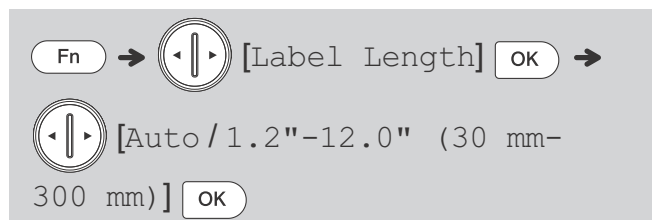

● NOTE

- appears in the Label Length area when you set a specific label length.
- To return to the default length (automatic, based on text length), press , and [Auto] appears on the LCD.

► Clearing Text and Settings

To delete individual letters and spaces, press .

To delete all text:



To delete all text and settings:



Printing Labels

► Preview

Preview

- Pressing the Preview key displays all of the text and the label length, then returns to the original text.
- Only the text can be previewed, not the font, style, size, underline/frame or any additional features.

► Feeding (Tape Feed)

Shift + Feed Print

- This function feeds approximately 1" (25 mm) of blank tape.
- When using the Chain Print feature, after the last label is printed, feed the tape.
- Do not pull the tape, as this may damage the Tape Cassette.

► Printing

Feed Print → [Set 1-9?1] [Left Arrow] [Right Arrow] / [1] - [9] [Left Arrow] → [OK]

- If you need only one copy of the label, press [OK] after you press [Feed Print].
- You can print up to nine copies of each label.
- DO NOT touch the Tape Cutter Lever while the message [Print] or [Feed] appears on the LCD.
- To cut tape:** When printing ends, press the Tape Cutter Lever.
- To remove tape backing, fold the label lengthwise (with the text facing inward), to expose the inside edges that run down the center of the tape backing. Peel and apply.

► Using Print Options

[Numbering]

You can print a series of up to 10 labels using auto-numbering. Use this feature to automatically increase a selected number by 1 after each one is printed.

Ex: Print copies of labels containing a serial number (0123, 0124, and 0125)

(Enter numbers) → [Left Arrow] [Right Arrow] by moving the cursor to the number you wish to increment.

0123 → [Fn] → [Left Arrow] [Right Arrow] [Print Option] [OK] → [Left Arrow] [Right Arrow] [Numbering] [OK] → [Left Arrow] [Right Arrow] [Set 3-9?5] [OK]

- Select the highest number you wish to print when setting the number.

[Mirror]

Ex: To Mirror Print "J.SMITH", follow the instructions below after entering "J.SMITH".

J.SMITH

(Enter text or characters) → [Fn] → [Left Arrow] [Right Arrow] [Print Option] [OK] → [Left Arrow] [Right Arrow] [Mirror] [OK] → [Mirror Print?] [OK]

- Use clear tape when using this function, so the labels can be read correctly from the opposite side when attached on glass, windows, or other transparent surfaces.

Setting Margins

The laminate mechanism creates a margin of about 1" (25 mm) at the beginning of printing. You can reduce this margin by printing labels continuously.

You can also change the margin before and after the text.

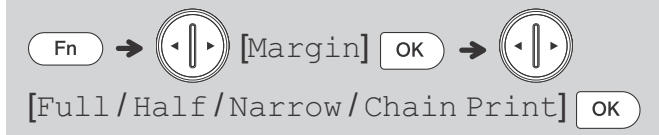

► [Full] / [Half] / [Narrow]

- The printed dots (:) indicate the end of the label. Cut along the printed dots (:) with scissors.

■ When printing a single sheet:

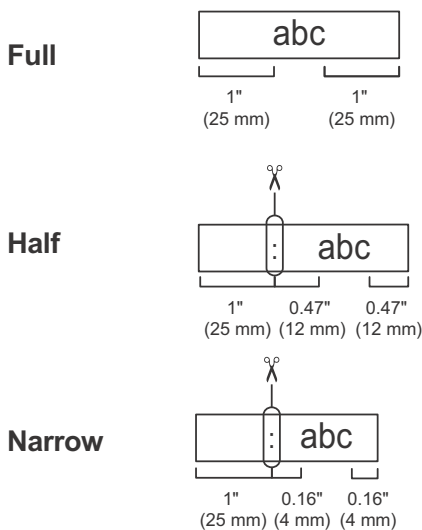

■ When printing multiple sheets:

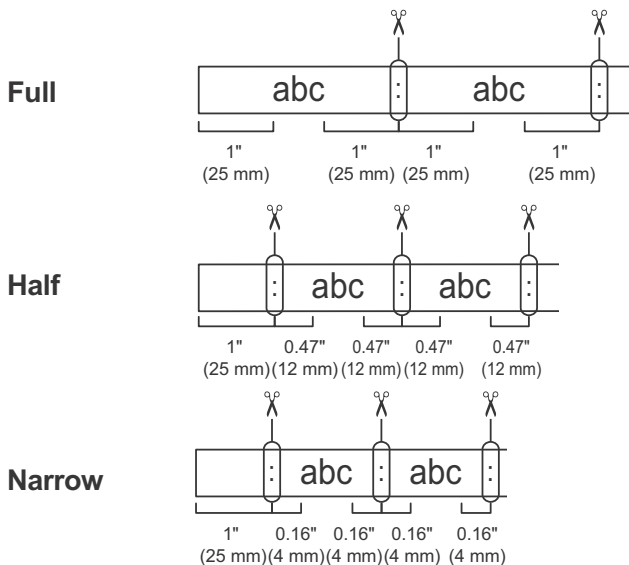

When selecting Half and Narrow margins, a mark will immediately follow the margin of about 1" (25 mm) indicating where to cut the label.

► [Chain Print] (Tape-saving option)

Use this option to print multiple labels with the narrowest margins. This feature saves tape.

Select [Chain Print] for the margin.

This setting does not print dots (:) indicating the end of the label. Use scissors to remove any part of margin that is not required.

1. Enter the text.

2. Press **Feed Print**. The message [Set 1-9?1] appears on the LCD.

3. Press the number keys to enter the amount of copies you want to print.

4. Press **OK** to start printing.

5. Clear the text and re-enter the text you want on the next label.

6. Repeat steps 2 through 5.

7. After the last label prints, feed the tape by

pressing **Shift** and **Feed Print**.

8. Press the Tape Cutter Lever.

● NOTE

- Once the final label sheet prints, feed the tape before pressing the Tape Cutter Lever (**Shift** + **Feed Print**), otherwise part of the text may be cut off.
- Do not pull the tape, as this may damage the Tape Cassette.

Setting Margins (cont)

- When printing multiple copies (2 to 9 copies of the same text):

Chain Print

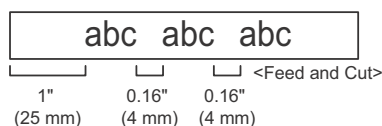

(ref) Narrow

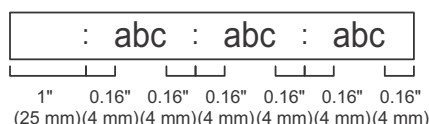

Once the final sheet prints, feed the tape, and press the Tape Cutter Lever.

- When printing multiple labels (different text):

Chain Print



(ref) Narrow

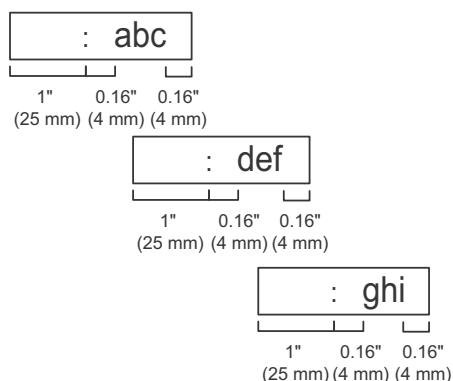

The printed labels will have the narrowest margin width when you use Chain Print. While the printed text is still inside the label maker, do not feed the tape until the final label is printed.

Once the final label prints, feed the tape, and press the Tape Cutter Lever.

Saving Labels Files

You can save and reuse the text and settings for up to five different labels. Each label holds up to 80 characters (including spaces). Assign a number (1-5) to each saved file so you can reuse it, and edit or overwrite stored files as needed.

► Saving a new file

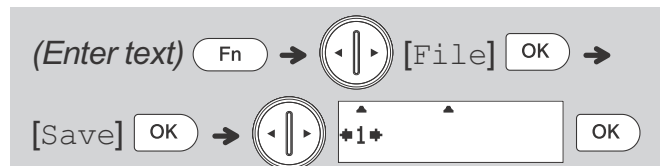

● NOTE

- When saving a file, if you reuse a number that is already assigned to another file, [Overwrite?] appears on the LCD. To overwrite the previously-saved file, press [OK]. To cancel without saving, press [Esc].

► Printing a saved file

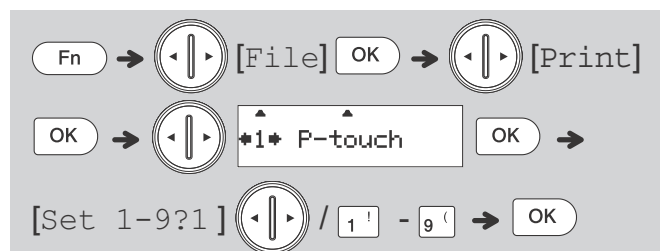

► Opening a saved file

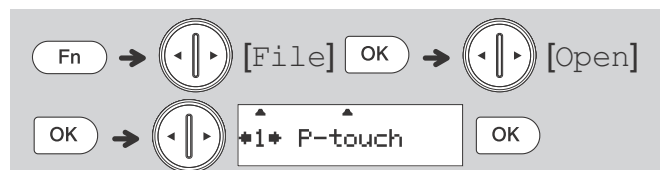

3 USING TEMPLATES

Auto Format

You can choose from six preset label lengths to create labels for various applications.

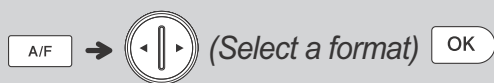

Applications	Label Lengths
CD Spine	4.5" (113 mm)
DVD Spine	5.8" (148 mm)
USB Stick	1.3" (34 mm)
Binder Spine	7.9" (200 mm)
File Folder	4.7" (120 mm)
Divider Tab	1.6" (42 mm)

4 DESIGNING LABELS

Setting Font

Font1

Display

F1: Helsinki

Label image

Helsinki 123

Font2

Display

F2: Venezia

Label image

Venezia 123

NOTE

- The actual printed font size depends on the tape width, number of characters and number of input lines. Once characters reach a minimum size, the selected font will default to a custom font which is based on the Helsinki style. This allows tapes to be printed using the smallest text possible on narrow or multi-line tapes.

Setting Font Size

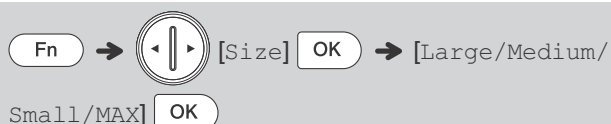

Label image

[Large]

ABCxyz

[Medium]

ABCxyz

[Small]

ABCxyz

[MAX]

ABCXYZ

NOTE

- Automatically adjusts the text size according to the tape width.
- The actual printed font size depends on the tape width, number of characters and number of input lines.
- Select MAX to print with maximum text size when using 0.70" (18 mm) tape, text is all Upper Case, the Style setting is [Normal], and the Underline/Frame setting is [Off].

Setting Font Width



Label image

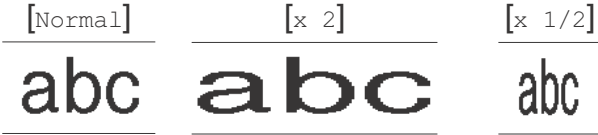

Setting Font Style



Label image

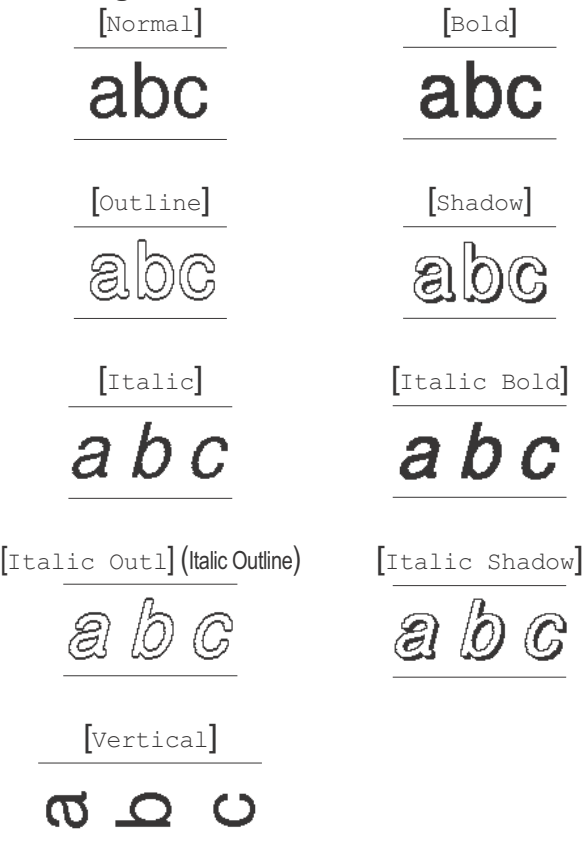

Setting Underline/Frame

Refer to the **Frame Designs** table section in this guide.

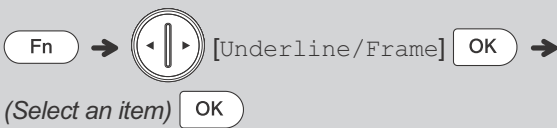

NOTE

- When using 0.13" (3.5 mm) tape, only [Underline] is available.

Setting Symbol

Press [Symbol] to select various symbols. Refer to the **Basic Symbols** and **Pictograph Symbols** table sections in this guide.



NOTE

- To go to the next group, press [Symbol].

5 HELPFUL HINTS

Shortcuts

Size	Fn → A
Width	Fn → B
Style	Fn → C
Underline/Frame	Fn → D
File	Fn → E
Label Length	Fn → F
Margin	Fn → G
Tab	Fn → H
Tab Length	Fn → I
Print Option	Fn → J
Auto Format	Fn → K
Language	Fn → L
Unit	Fn → M

Helpful Tips

Feed	↑Shift → Feed Print
Cancel Operation	Esc or ⏮

Resetting the Machine

Reset your label maker when you want to initialize the settings or in the event it is not working properly. Resetting clears all the text, settings, and stored files. It also clears the language and unit of measurement settings.

1 Turn off the label maker, hold down **Space** and **Esc**, and then press  to turn the label maker back on.

2 First release the power button, and then release **Space** and **Esc**.

The label maker turns on with the internal memory reset.

If you encounter any problems with your product, please do not return your product to the store.

After referring to the User's Guide, if you still need assistance or need to locate a service center, contact Brother Customer Service at:

(In USA)

Voice: 1-877-BROTHER

Web: www.brother-usa.com

Fax: 1-901-379-1210

To order supplies and accessories, visit www.brothermall.com or call 1-877-552-6255.

NOTE

CAUTION

- Remove the batteries if you do not intend to use the label maker for an extended period of time.
- Dispose of batteries at an appropriate collection point, not in the general waste stream. Be sure to observe all applicable federal, state, and local regulations.
- When storing or discarding a battery, wrap it with cellophane tape, to prevent it from short-circuiting. (See illustration)

1. Cellophane tape



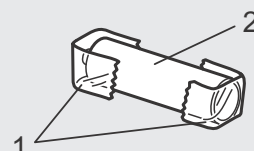

2. Alkaline battery

Do not mix old and new batteries. Replace all six batteries at the same time.





Troubleshooting

► Error messages

Message	Cause / Remedy
Invalid!	<ul style="list-style-type: none"> There is no text above the cursor when you selected [Numbering]. An invalid character was selected for [Numbering]. An invalid value was selected for [Tab Length] or [Label Length]. An invalid value was entered as the label length while using templates.
No Text!	<ul style="list-style-type: none"> You tried to print a text file when there was no data stored in the memory. You pressed  when no text was entered. You selected [Print Option] when no text was entered. You pressed  when no text was entered.
Line Limit!	<ul style="list-style-type: none"> You tried to enter a 3rd line by pressing . You tried to print or preview two lines of text while 0.13" (3.5 mm) or 0.23" (6 mm) tape was installed. Install a larger tape size.
No Cassette!	Install a Tape Cassette.
Cutter Error!	The Tape Cutter Lever was pressed in the middle of the printing process.
Text Full!	The text exceeds the maximum number of characters (80 characters).
Text Too Long!	<ul style="list-style-type: none"> The text length exceeds the selected label length or the selected Auto Format setting length. Select a longer label size or [Auto] for a longer label length. Refer to the Changing Label Length section in this guide. Select a longer preset label format in Auto Format. Refer to the Auto Format section in this guide. Select [$\times 1/2$] font size. Refer to the Setting Font Width section in this guide.
No Frame OK?	Printing on 0.13" (3.5 mm) tape with an invalid Frame setting ON. (Select  to print with no Frame,  to cancel.)
Battery Weak!	The batteries are weak. If using alkaline batteries, replace them with new ones.
Check Battery!	The installed batteries are running low and need to be replaced for continued operation.

► What to do when...

Problem	Solution
The display stays blank after you have turned on the machine.	<ul style="list-style-type: none"> Check that the AC Adapter is correctly connected. Check that the correct AC Adapter (AD-24ESA-01/AD-24ESAW-01) is used. Check that the batteries are correctly inserted. The batteries may be weak. Replace them. Check that the protective film is removed.
When the label is printed, there is too much margin (space) on both sides of the text.	<ul style="list-style-type: none"> Refer to the Setting Margins section in this guide and select [Half], [Narrow] or [Chain Print] for smaller margins. Due to the structure of the laminate, when you set [Half] or [Narrow], the label maker feeds approximately 1" (25 mm) of leader tape before every new label. To save tape, set [Chain Print]. After the last label prints, press  and  to feed the tape, and then press the Tape Cutter Lever. Check if ▼ appears in the Label Length area. If so, Auto Format or label length is set. Set Auto Format [Off] and label length [Auto]. Or reset the machine. Refer to the Resetting the Machine section in this guide.
The machine does not print, or the printed characters are not formed properly.	<ul style="list-style-type: none"> Check that the Tape Cassette is inserted correctly. Replace the Tape Cassette if striped tape is visible, as this indicates that you have reached the end of the tape. Check that the Cassette Cover is closed correctly. Clear the format settings. Press  and select [Text & Format]. Reset the machine. Refer to the Resetting the Machine section in this guide.
The setting has cleared on its own.	<ul style="list-style-type: none"> Check that the AC Adapter is correctly connected. The batteries may be weak. Replace them. When the power is disconnected for more than five minutes, all text and formats in the display settings will be cleared.
The machine is locked and nothing happens when keys are pressed.	Reset the machine. Refer to the Resetting the Machine section in this guide.
The power turns off when you try to print.	<ul style="list-style-type: none"> Check that the AC Adapter is correctly connected. Check that the correct AC Adapter (AD-24ESA-01/AD-24ESAW-01) is used. The batteries may be weak. Replace them. Check that the batteries are correctly inserted.

Troubleshooting (cont)

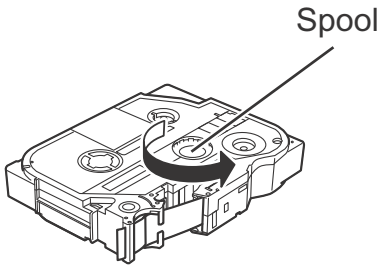
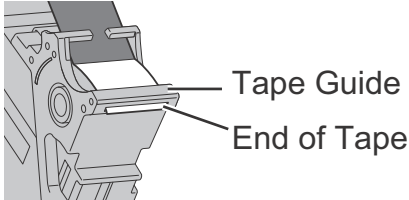
Problem	Solution
The ink ribbon is separated from the ink roller.	<p>If the ink ribbon is broken, replace the Tape Cassette. If not, leave the tape uncut and remove the Tape Cassette, then wind the loose ink ribbon back onto the spool.</p> 
The tape does not feed properly or the tape gets stuck inside the machine.	<ul style="list-style-type: none"> Check that the end of the tape feeds under the Tape Guide.  <ul style="list-style-type: none"> The Tape Cutter Lever is pressed while printing. Do not touch the Tape Cutter Lever during printing.
While printing, striped tape appears.	The Tape Cassette is empty. Insert a new Tape Cassette.
All text and format settings need to be cleared to create a new label.	Press Clear and select [Text & Format].
A blank horizontal line appears through the printed label.	<ul style="list-style-type: none"> There may be some dust on the Print Head. Remove the Tape Cassette and use a dry cotton swab to gently wipe the Print Head with an up-and-down motion. * The Print Head can be cleaned more easily if the optional Print Head Cleaning Cassette (TZe-CL4) is used.





















Basic Symbols

. , : ; " ' •
? ! & _ \ / -
* @ # % °
+ - × ÷ =
\$ ¢ € £ ¥
() [] < >
→ ← ↑ ↓
● ○ ★ ☆ ♥ ♡ ◆

Pictograph Symbols

☎ 📞 ✉ 📧 🖥 📺 🎧 📷 🔌
🧠 🔑 🎧 📞 📧
🚲 🏊 🚗 🧑 🧒 🧒 🧒
🐶 🐱 🐰 🐵 🍀 🌻 🌴
✓ ⚡ 💕 🎵 🐾 🏰 🌈
🍷 🌲 🧑 🧑 🍁 📺
🍷 🍺 🍲 🍰 🍏

Accented Characters							
A	Á Â Ã Ä Å Æ Æ Ą Ą Ą Ą			a	á à â ä æ ã ạ ả ă ă		
C	Ç Ć Ć	D	Đ Đ	c	ç ċ ċ	d	d' ð đ
E	É Ê Ë Ě Ě Ě Ě			e	é è ê ë ě ě ě ě		
G	Ġ Ġ	I	Í Î Ï Ĭ Ĭ Ĭ Ĭ	g	ğ ğ	i	í î ï ĭ ĭ ĭ ĭ
K	Ķ	L	Ł Ł Ł Ł	k	ķ	l	ł ł ĺ ĺ
N	Ñ Ñ Ñ Ñ	R	Ř Ř Ř	n	ñ ñ ñ ñ	r	ř ř ř
O	Ó Ò Ô Ø Ö Õ Œ Œ			o	ó ò ô ø ö õ œ õ		
S	Š Š Š Š ß	T	Ť Ť Þ	s	š š š š ß	t	t' ț þ
U	Ú Û Ü Ü Ů Ů Ů Ů			u	ú û ü ü ů ů ů ů		
Y	Ý Ÿ	Z	Ž Ž Ž	y	ý ŷ	z	ž ž ž

Frame Designs *			
Underline	 abcde	Books	
Round		Tools	
Octagon		Party	
Banner		Dog	
Emphasis		Pets	
Bubble		Spring	
Square		Summer	
Brackets		Autumn	
Arabesque		Winter	
Leaf		Happy	

Note: Images are for illustrative purposes only.

Federal Communications Commission (FCC) Supplier's Declaration of Conformity (USA)

Responsible Party: Brother International Corporation
200 Crossing Boulevard
Bridgewater, NJ 08807-0911, U.S.A.
TEL: (908) 704-1700

Product Name: Label Writer
Model Number: PT-2040

This equipment complies with Part 15 of the FCC Rules. Operation is subject to the following two conditions: (1) This equipment may not cause harmful interference, and (2) this equipment must accept any interference received, including interference that may cause undesired operation.

This equipment has been tested and found to comply with the limits for a Class B digital device, pursuant to Part 15 of the FCC Rules. These limits are designed to provide reasonable protection against harmful interference in a residential installation. This equipment generates, uses and can radiate radio frequency energy and, if not installed and used in accordance with the instructions, may cause harmful interference to radio communications. However, there is no guarantee that interference will not occur in a particular installation. If this equipment does cause harmful interference to radio or television reception, which can be determined by turning the equipment off and on, the user is encouraged to try to correct the interference by one or more of the following measures:

- Reorient or relocate the receiving antenna.
- Increase the separation between the equipment and receiver.
- Connect the equipment into an outlet on a circuit different from that to which the receiver is connected.
- Consult the dealer or an experienced radio/TV technician for help.

Important

Changes or modifications not expressly approved by Brother Industries, Ltd. could void the user's authority to operate the equipment.



DON'T FORGET TO REGISTER!

If you complete and submit your registration, your product will be officially registered with Brother International Corporation and you'll automatically be entered into our monthly \$1,000 "Click To Win" contest.

Registering your product will provide purchase confirmation, proof of ownership and, if you choose, allows us to notify you of product enhancements and special offers!

Simply fill out the enclosed warranty card or if you prefer, you can register on-line by visiting us at:

www.registermybrother.com

- Sweepstake open to legal U.S. residents 21 years of age and older.
- Subject to all federal, state, and local laws and regulations. Void where taxed, prohibited, or otherwise restricted by law.
- See Web site for complete details.