

PT-E100 User's Guide English Español

With your PT-E100, you can create labels for multiple applications. Select from the many character sizes and styles to design professional looking custom labels.

Printed in China LAB662001

Safety Precautions

WARNING Indicates a potentially hazardous situation which, if not avoided, could result in serious injuries.

Follow these guidelines to avoid the risk of fire, burns, injury, electric shock, rupture, overheating, abnormal odor or smoke.

- Always use the specified voltage and the recommended AC adapter (AD-24ES) for the P-touch labeler to prevent any damage or failure. Do not touch the P-touch labeler during a lightning storm.

CAUTION Indicates a potentially hazardous situation which, if not avoided, may result in minor or moderate injuries.

Follow these guidelines to avoid personal injury, liquid leakage, burns or heat.

- When the P-touch labeler is not being used, store it out of the reach of children. In addition, do not allow children to put the P-touch labeler parts or labels in their mouths.

FCC NOTICE

This device complies with Part 15 of the FCC Rules. Operation is subject to the following two conditions: (1) This device may not cause harmful interference, and (2) This device must accept any interference received, including interference that may cause undesired operation.

General Precautions

- Depending on the location, material, and environmental conditions, the label may unpeel or become irremovable, the color of the label may change or be transferred to other objects.

BASIC USAGE

Entering Text

Switching Upper Case/Lower Case

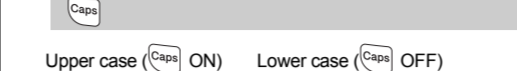

Making Two Lines of Text

- Enter the text for the first line and then press [Enter] for the second line. Move the cursor to where the second line starts and press [Enter].

NOTE

Do not press [Enter] after the second line; otherwise the "Line Limit" error message will appear.

To Clear

Press [Clear] to delete the letters one by one. To delete all text and settings :

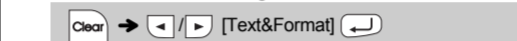

Entering Tab



NOTE

Entering a Tab will position the cursor to the next Tab Length starting from the left side of the label and not from the last character position.

NOTE

When using the optional AC adapter (AD-24ES) 1. Connect the AC adapter into the AC adapter socket on the bottom of the machine.

Entering Accented Characters

Table with columns for characters A-Z and their accented versions (e.g., Á, Ä, Å, Æ, etc.)

Changing Label Length

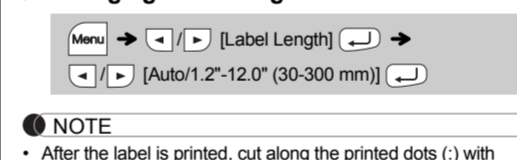

NOTE

The machine automatically turns off if no keys are pressed within five minutes. To cancel any operation, press [Power Off].

Reset the PT-E100

You can reset your PT-E100 labeling system when you need to initialize the settings, or if the PT-E100 is not working properly.

- Turn off the P-touch labeler, hold down [Menu] and [R] and then press [Power Off] to turn the P-touch back on.

Accessories

Tape Cassettes: See the included "Supplies and Accessories Guide". Cutter Unit: TC-4 (replacement). If the cutter blade becomes dull after repetitive use and the tape cannot be cut cleanly, replace with a new cutter (stock no. TC-4).



- Install a new cutter unit. Push it in until it snaps into place. Do not touch the cutter blade directly with your fingers.

Printing Labels

Preview

You can preview the text before printing. This is not a preview image of the label, just the text on the label.

Feeding (Tape Feed)

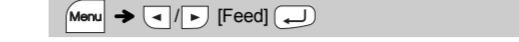

NOTE

- If you need only 1 copy of the label, press [Copies: 1] without selecting the number of copies. The number of copies can also be specified by pressing a number key.

Setting Margin



[Full]/[Half]/[Narrow]

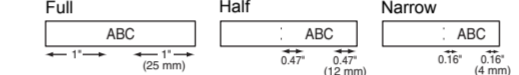

[Chain Print]

- For batch printing without ejecting each label. 1. Enter text. 2. Press [Print], then [Copies:] appears.

NOTE

When [Half] or [Narrow] is set, the displayed label length is the length from the printed dots (·) to the end of the label.

Changing Label Length

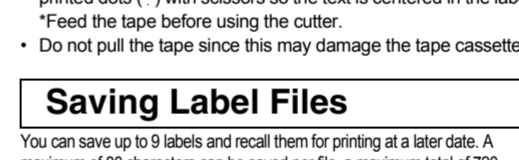

Saving Label Files

You can save up to 9 labels and recall them for printing at a later date. A maximum of 80 characters can be saved per file, a maximum total of 720 characters for the total memory.

Text Keys

Press [Menu]+[1/2/3] to select the settings to enter the text.

NOTE

If you try to store a label when there is already a label stored to that number, a message "Overwrite?" will appear. Press [Enter] to save your new label. Press [Clear] to cancel.

Replacing the Cutter Unit

- Full out the two sections of the cutter unit (green) in the direction of the arrows shown in the illustration.

- Install a new cutter unit. Push it in until it snaps into place. Do not touch the cutter blade directly with your fingers.

USING TEMPLATES

Cable Wrap

You can create a label that can be wrapped around a cable or wire. The input text line is rotated 90° counterclockwise and printed on a label whose length is automatically determined by setting the cable diameter.

With the CableRot/Rpt function, the text is printed repeatedly along the length of the label so that it can easily be read from any angle.

Select a cable diameter and press [Print].

Cable diameter: 0.2" to 3.6" (3mm to 90mm) available. Default: 0.3" (6mm).

NOTE

For labels attached to cables and wires, we recommend using Flexible ID Tape. Use the cable flag function when the diameter of the object is less than 0.2" (3mm).

Faceplate

Labels printed with this function can be used to identify various components or panels. A block of text is evenly spaced on a single label.

Select a faceplate length and press [Print].

NOTE

To position the text appropriately for multiple ports in a single print, either use the chain print function with the Faceplate length equal to the port width, or enter the Faceplate length equal to the total length over all the ports and then use the tab function to space out each port data.

Underline and Frame

You can select the desired frame design. Select a frame type and press [Print].

NOTE

Frames cannot be printed on 0.13" (3.5mm) tape. Press [Menu]+[1/2/3] to select the settings to enter the text.

Short Cut Keys

Table mapping menu keys (1-8) to functions: Tab, Tab Length, Preview, Margin, Unit, Feed, Language.

Text Keys

Press [Menu]+[1/2/3] to select the settings to enter the text.

Press [Menu]+[1/2/3] to select an item.

Press [Menu]+[1/2/3] to select the settings.

Press [Menu]+[1/2/3] to select the settings to enter the text.

Press [Menu]+[1/2/3] to select the settings to enter the text.

Press [Menu]+[1/2/3] to select the settings to enter the text.

Press [Menu]+[1/2/3] to select the settings to enter the text.

Cable Flag

With this function, a label can be wrapped around a cable or wire with its ends stuck together to form a flag. The input text lines are printed at the both ends of a label.

You can select the desired flag length. When [Auto] is selected, the flag length is automatically adjusted according to the text length.

Select a flag length and press [Print].

Flag length: 0.4" to 8.0" (10mm to 200mm), Auto Default: Auto.

NOTE

To clear all text, press [Clear], select [Text&Format] or [Text only], then press [Enter]. Press [Clear] to cancel.

Serialize

Using the Serialize function, you can print multiple labels with a number or letter automatically incremented on each label. This serializing function can also be used with the Cable Wrap, Cable Flag or Faceplate templates to save time entering and printing a series of labels.

Select a character to be ascended and press [Print].

NOTE

Text cannot be rotated in the Cable Flag function. Press [Menu]+[1/2/3] to select one of 12 symbol categories.

Use [Menu]+[1/2/3] to select the desired symbol.

Select a symbol.

Select a category.

Select a symbol.

Select a symbol.

Select a symbol.

Select a symbol.

Select a symbol.

Select a symbol.

Select a symbol.

Select a symbol.

Select a symbol.

Select a symbol.

Select a symbol.

Select a symbol.

Select a symbol.

Power Supply and Tape Cassette

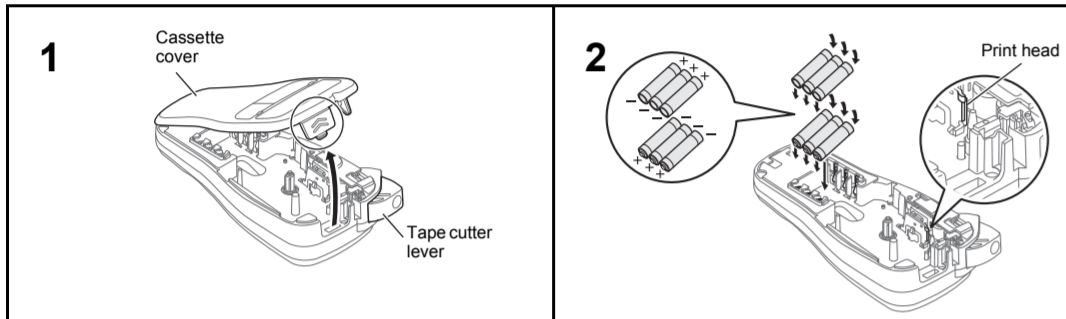

Open the cassette cover by pressing the above indicated area at the top end of the machine.

If a tape cassette is already installed, remove it by pulling it straight up. Also, if batteries are already installed, remove them.

- Make sure that the power is turned off when replacing batteries or tape cassettes.

Insert six new AAA alkaline batteries (LR03; not included) or fully charged Ni-MH batteries (HR03; not included), making sure that their poles point in the correct directions.

Users of alkaline batteries: Always replace all six batteries at the same time with brand new ones.

Users of Ni-MH batteries: Always replace all six batteries at the same time with fully charged ones.

NOTE

Visit us at http://solutions.brother.com/ for the latest information about the recommended batteries.

LCD Display & Keyboard

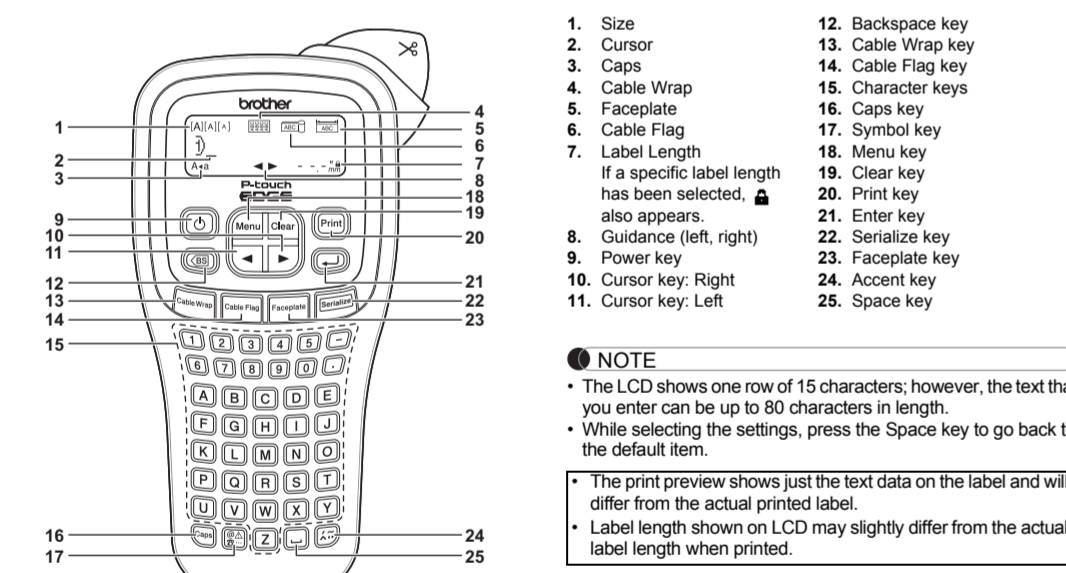

- 1. Size 2. Cursor 3. Caps 4. Cable Wrap 5. Faceplate 6. Cable Flag 7. Label Length

NOTE The LCD shows one row of 15 characters; however, the text that you enter can be up to 80 characters in length.

- The print preview shows just the text data on the label and will differ from the actual printed label.

Specifications

Dimensions: (W x D x H) Approx. 4.4" x 8.2" x 2.4" (Approx. 110(W) x 208(D) x 59(H)mm) Weight: Approx. 0.9 lb. (Approx. 390 g) (without batteries and tape cassette)

Power supply: Six AAA alkaline batteries (LR03) Six AAA Ni-MH batteries (HR03)*1 Optional AC adapter (AD-24ES)

Tape cassette: Brother TZe tape (width) 0.13" (3.5mm), 0.23" (6mm), 0.35" (9mm), 0.47" (12mm) Brother HGe tape (width) 0.23" (6mm), 0.35" (9mm), 0.47" (12mm)

NOTE

Visit us at http://solutions.brother.com/ for the latest information about the recommended batteries.

What to do when...

Table with columns for Problem and Solution, detailing troubleshooting steps for display, tape, and power issues.

Initial Settings

1 Start your machine.

Supply power by using six AAA batteries, and then press [Power On].

2 Set the language.

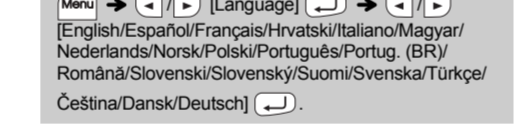

3 Set the unit of measurement.

The default setting is [inch].

NOTE

The machine automatically turns off if no keys are pressed within five minutes.

Troubleshooting

Error message

Table with columns for Message and Cause/Remedy, detailing error messages like Low Battery, Battery Dead, Invalid!, No Data, Line Limit, and No Cassette!

Message Cause/Remedy

Table with columns for Message and Cause/Remedy, detailing error messages like Cutter Error, Text Full!, Text Limit!, No Frame OK?, OK to Feed?, Wrong Tape!, No Data!, Line Limit!, and No Cassette!

Problem Solution

Table with columns for Problem and Solution, detailing troubleshooting steps for the machine being locked up, power turning off, tape not feeding, and LCD language issues.

Contact Information

Brother Mobile Solutions, Inc. 100 Technology Drive, Suite 250A Broomfield, CO 80021 www.brothermobilesolutions.com