

Symbols and special characters

International characters

You can create international characters by combining a letter and a diacritical (accent). Diacriticals available on the keyboard are ` and ^. To add a diacritical to a character, enter the character first, followed immediately by the diacritical. For example, press 'E' followed by '^' to get é.

To add a diacritical to an existing character, use ◀ or ▶ to place the cursor under the character to be changed, then press the appropriate diacritical key.

Symbols

Pressing (SYM) changes the display to show symbols and special characters, some of which are not available direct from the keyboard. The display will show:

α-o? (or α-r? where available).

Each letter selects a line of five symbol characters, as shown in the table below. Note that some of the more complex printed symbols are represented by simpler symbols in the display. Press (DEL) to cancel or press the letter key required.

Use ◀ or ▶ to select a symbol. Press (SYM) again to place the symbol in the label, or press (PRINT) to place it and print the label.

	DISPLAYED CHARACTERS	PRINTED CHARACTERS
a	\$ ¢ £ Fr ¥	\$ ¢ £ Fr ¥
b	@ & # : ;	@ & # : ;
c	" < > ± =	" < > ± =
d	\ ÷ X % *	\ ÷ X % *
e	°R °C T M ∞ °	® © TM ∞ °
f	2 3 1/2	2 3 1/2
g	± † ‡ μ Ω	± † ‡ μ Ω
h	· 1 · 2 · 3 · 4 · 5 ·	△ ▲ ▽ ▹ ▸
i	· 6 · < > ↑ ↓	⊗ ← → ↑ ↓
j	Æ Å Ç Æ Ø	Æ Å Ç Æ Ø
k	æ å ç œ ø	æ å ç œ ø
l	Ã Ë Ñ Õ	Ã Ë Ñ Õ
m	ã ë ñ õ	ã ë ñ õ
n	â ê î ô û	â ê î ô û
o	ß ç ï ● ★	ß ç ï ● ★
p	Á É Í Ó Ú	Á É Í Ó Ú
q	á é í ó ú	á é í ó ú
r	ì ò !	ì ò !

Note: Rows p, q and r where available.

Print contrast — may be adjusted by pressing (SYM) followed by the space key to display five contrast symbols. Use ◀ or ▶ to select a symbol. Press (SYM) again to confirm the setting. The contrast level will revert to the mid-setting when the Labelmaker is turned off and on again.

Troubleshooting

No display

- check machine is on
- replace discharged batteries or use the AC adaptor
- check AC adaptor plugged in and switched on.

No printing or poor text

- replace discharged batteries or use the AC adaptor
- check tape cassette installed correctly and tape not kinked
- replace the tape cassette.

No response to print key

- label length too short for text – press ▶ until > disappears or clear fixed length
- !!!!! in display indicates a printer jam. Printing will stop and the display return to normal. Open the cassette compartment and free the jam.
- □□□□ flashing in the display indicates low battery volts. Replace discharged batteries or use the AC adaptor.

Accessories

12mm (1/2") cassettes	
Black/Clear	45010
Blue/Clear	45011
Red/Clear	45012
Black/White	45013
Blue/White	45014
Red/White	45015
Black/Blue	45016
Black/Red	45017
Black/Yellow	45018
Black/Green	45019
Replacement Cutter	15030
Carrying Case	15010
AC Adaptor	40030

This product is designed to conform with the following international standards:

EN 60950 IEC 950 UL 1950 Specification for safety of information technology equipment including electrical business equipment

EN 55022 Class B Specification for limits and methods of measurement of radio interference characteristics of information technology equipment.

FCC pt15 Sub pt B Class B Federal communications commission radio frequency emissions.

Written by DAW Publications, Cambridge

DYMO 1000 Electronic Labelmaker Instructions for Use

Power supply

Insert five size AA alkaline or nickel-cadmium re-chargeable batteries, observing the polarity markings. Re-chargeable batteries must be charged externally before use.

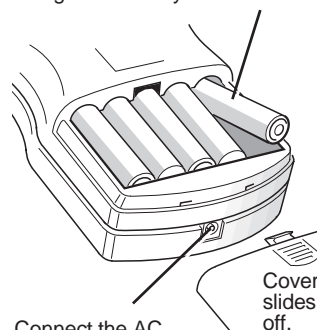

Connect the AC adaptor plug here. Use only the recommended adaptor. Plugging in the AC adaptor disconnects the batteries. Note: Re-chargeable batteries will not be charged.

Cassette door

To remove the door, press in where shown below then swing the door open and lift it away.

When re-fitting, hold the door at the angle shown below and engage the tabs on the door in the slots in the case.

Now close the door, ensuring that the lever engages with the ramp on the door as it closes.

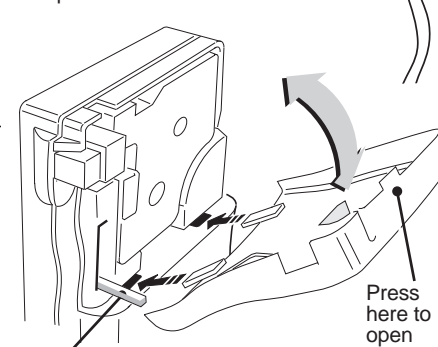

Ensure this lever engages with ramp on door when closing.

Cleaning

Use a ball pen or pencil to hold down interlock button.

Use a cotton bud and alcohol to clean both sides of cutter blade regularly.



4 Check and clean print head and pinch roller regularly using cotton bud and alcohol ONLY.

Changing the cassette

Ensure tape and ribbon is taught across mouth of cassette and tape passes between the guide posts before installing.

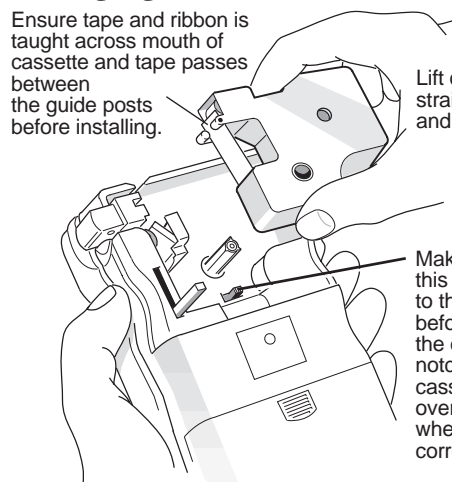

Lift cassette straight up and out.

Make sure that this switch is set to the RIGHT before installing the cassette. A notch in the cassette will fit over the switch when it is set correctly.

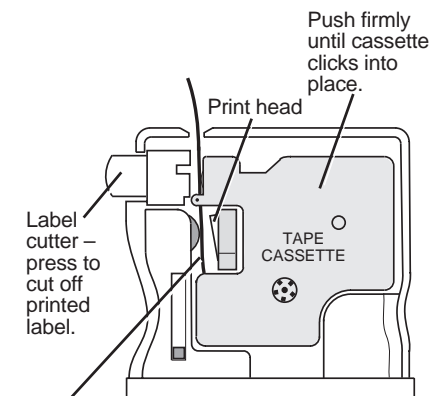

Ensure tape and ribbon are positioned as shown between print head and pinch roller.

